

## BI-FOLDING GATES SYSTEM KIT

### Description

All items contained in the kit are made of galvanized steel and is specially designed for use on bi-folding applications. The gates on which the kit is used can be motorized. The system allows for the gate folding parts to move simultaneously. In the open position the gate will occupy a space little more than half of the overall clearance.



#### Family of parts

KC7101

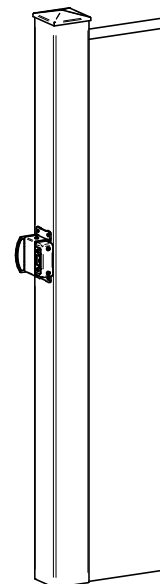
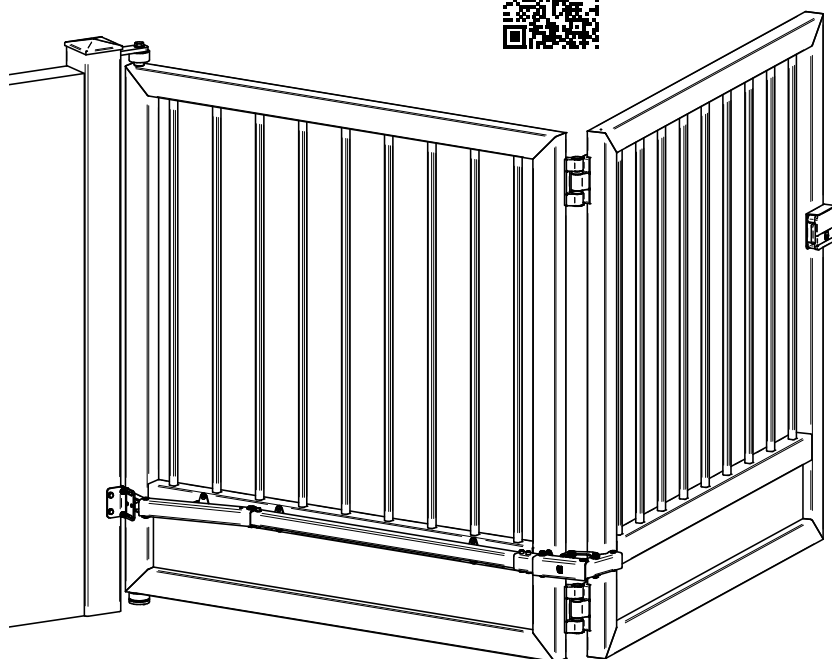
SCAN FOR MORE INFO

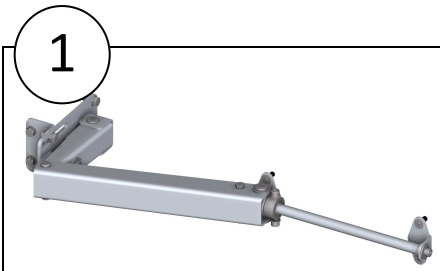
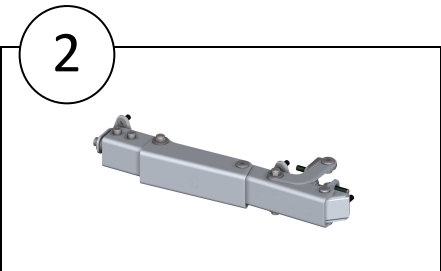

### Elenco parti *Component list*

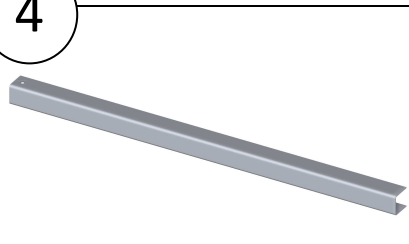
|  |   |
|--|---|
| 1x   | 1x  |
| <div>1</div>  | <div>2</div>  |
| 2x   | <i>Optional 40x40x2</i>   |
| <div>3</div>  | <div>4</div>  |

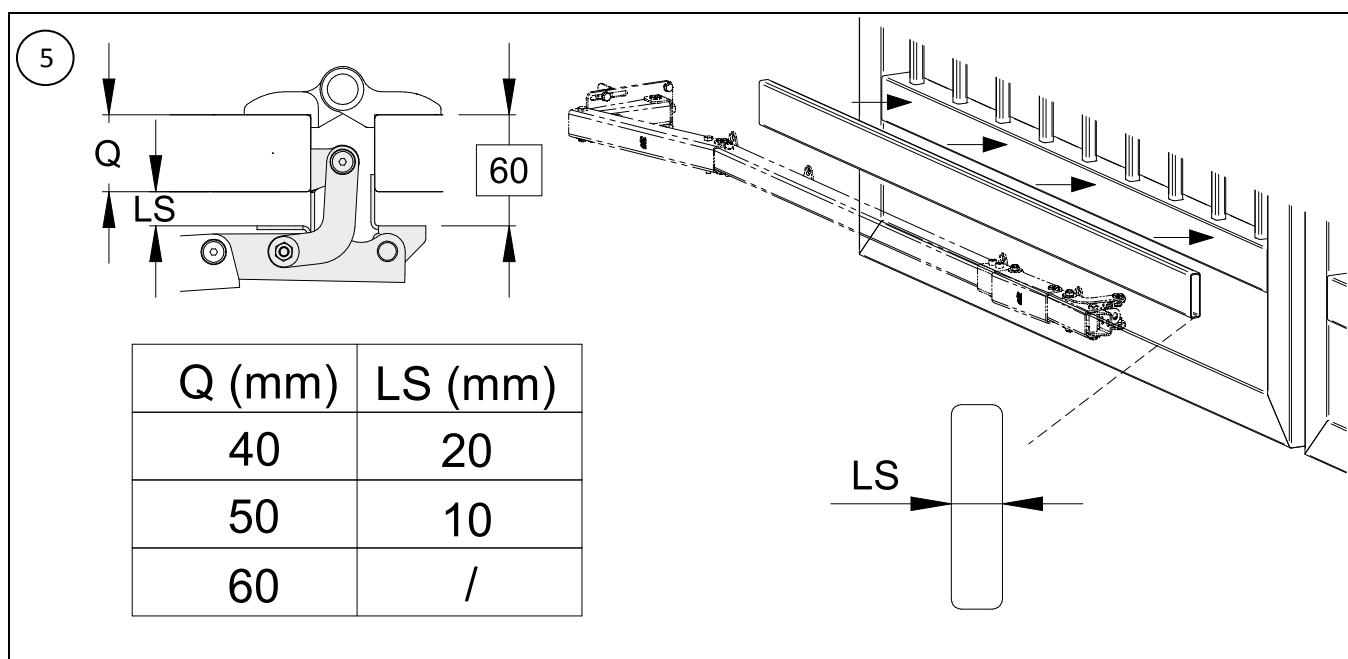
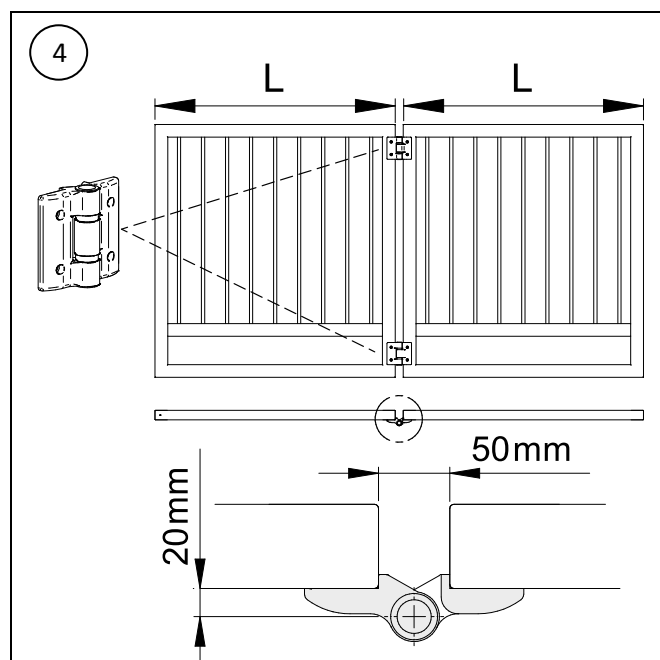
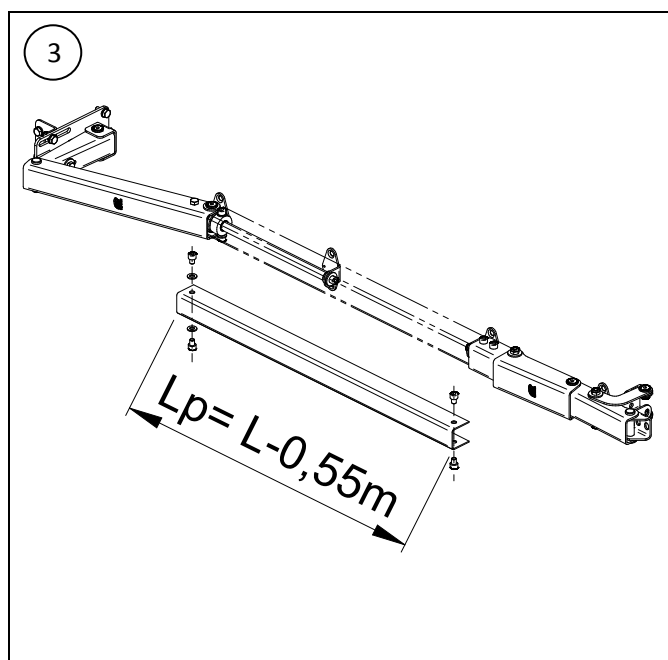
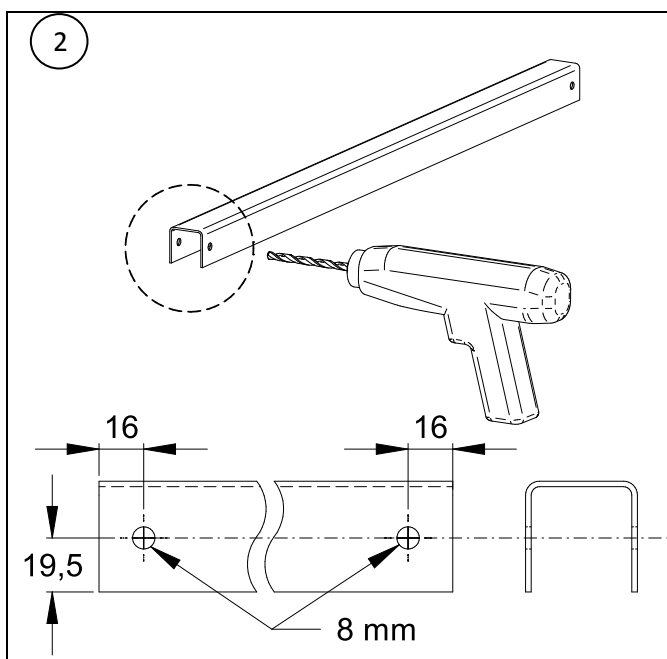
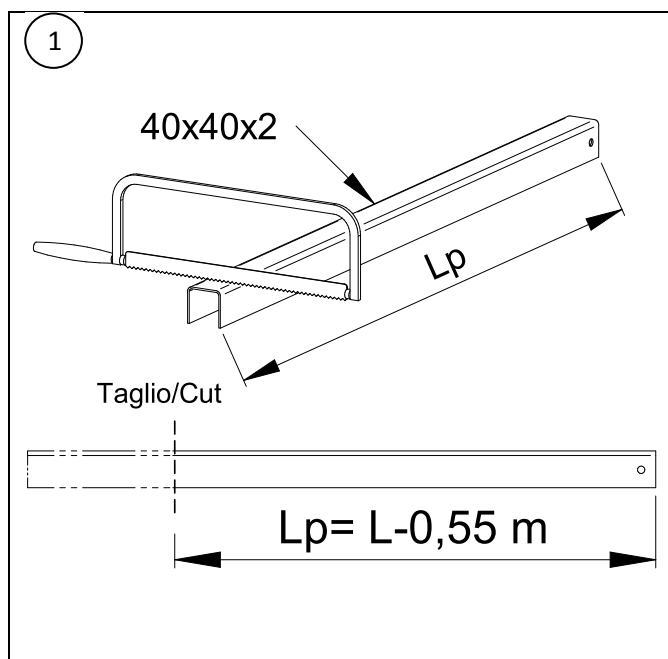

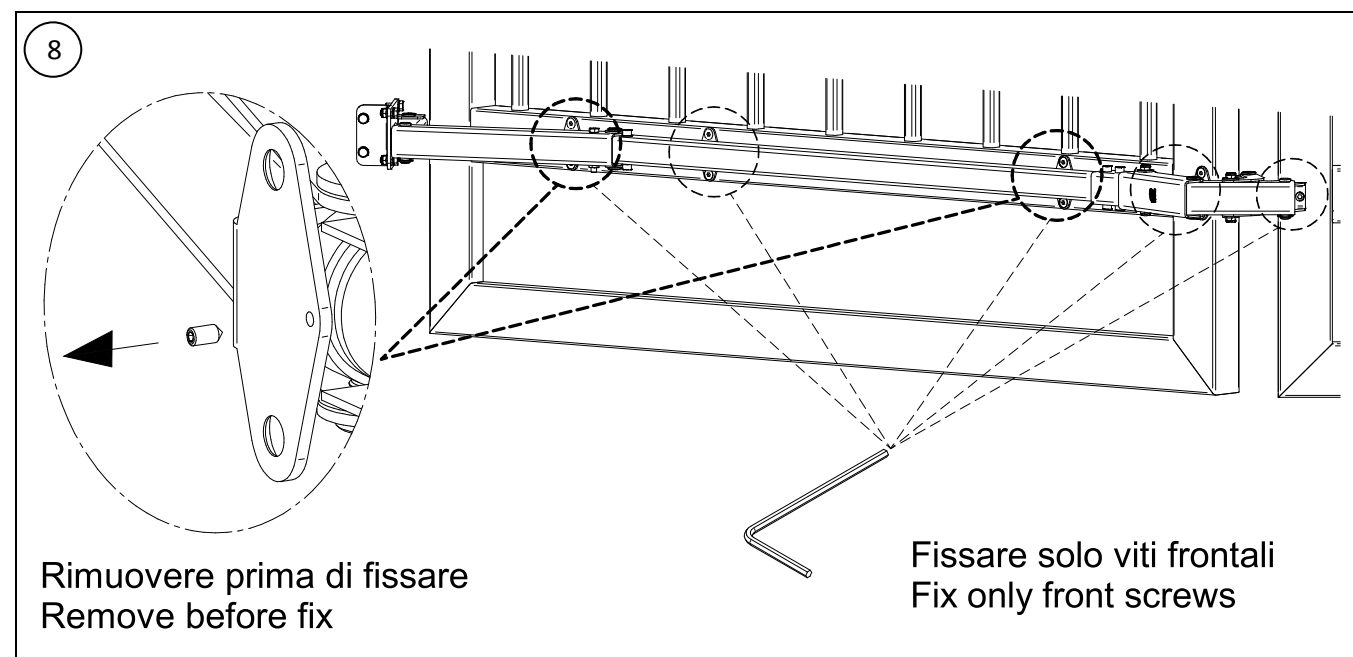
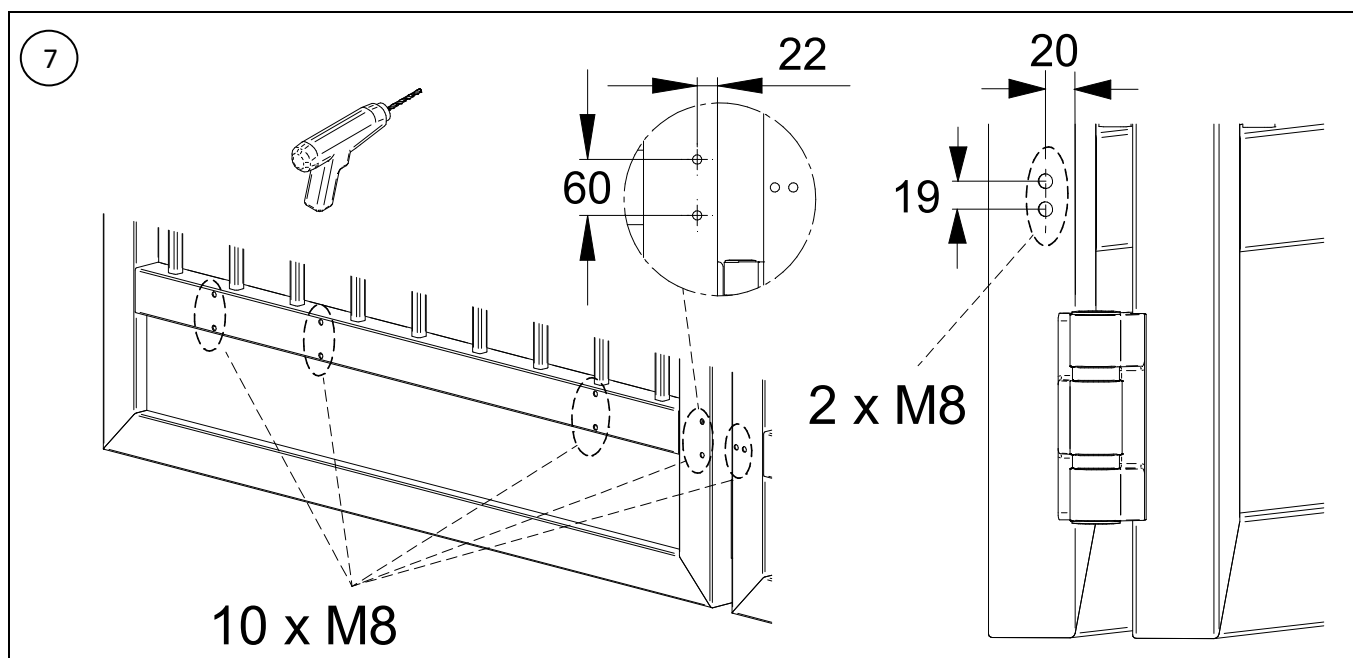
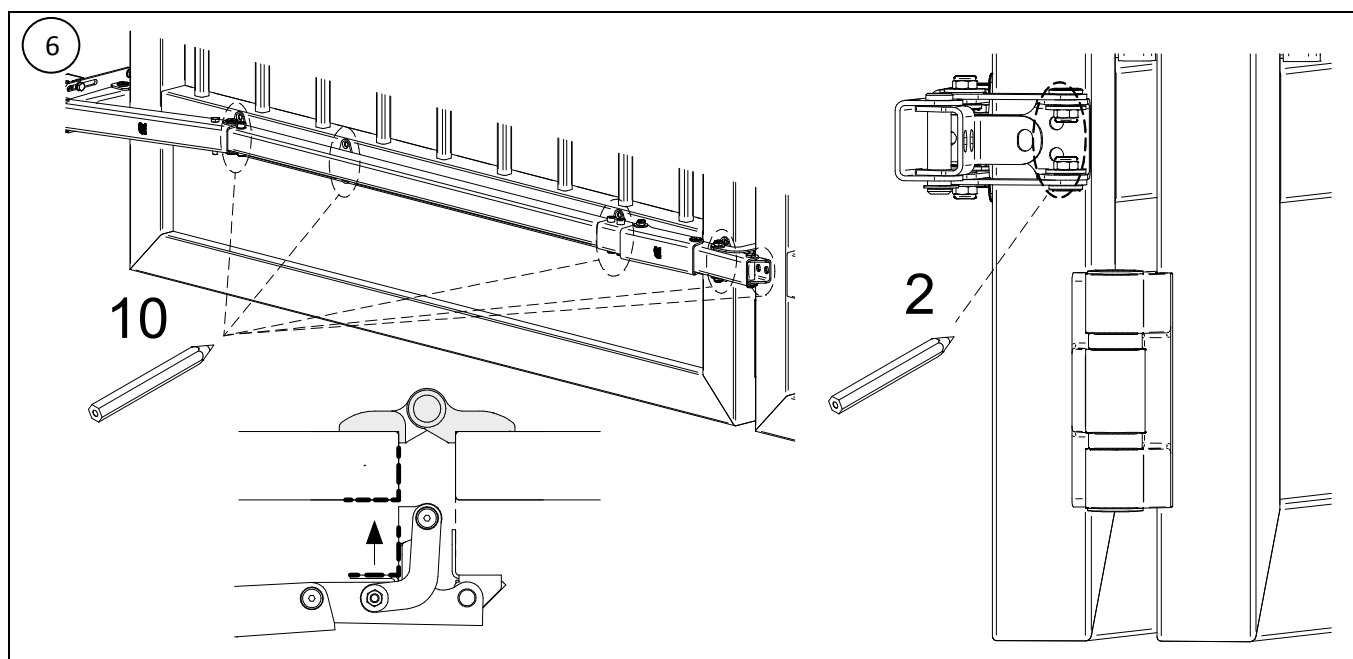

**Attention:** installations that do not comply with the illustrated procedure or failure to carry out correct maintenance operations can cause the gate to derail and endanger the safety of persons and property

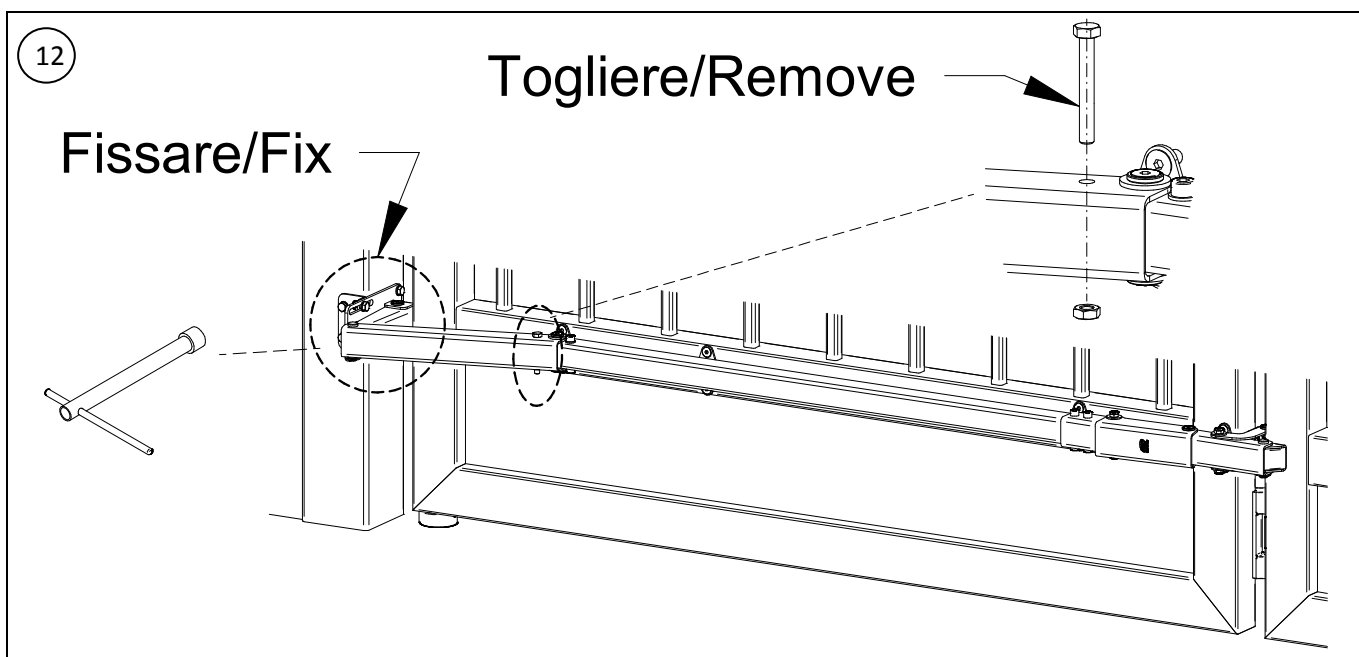
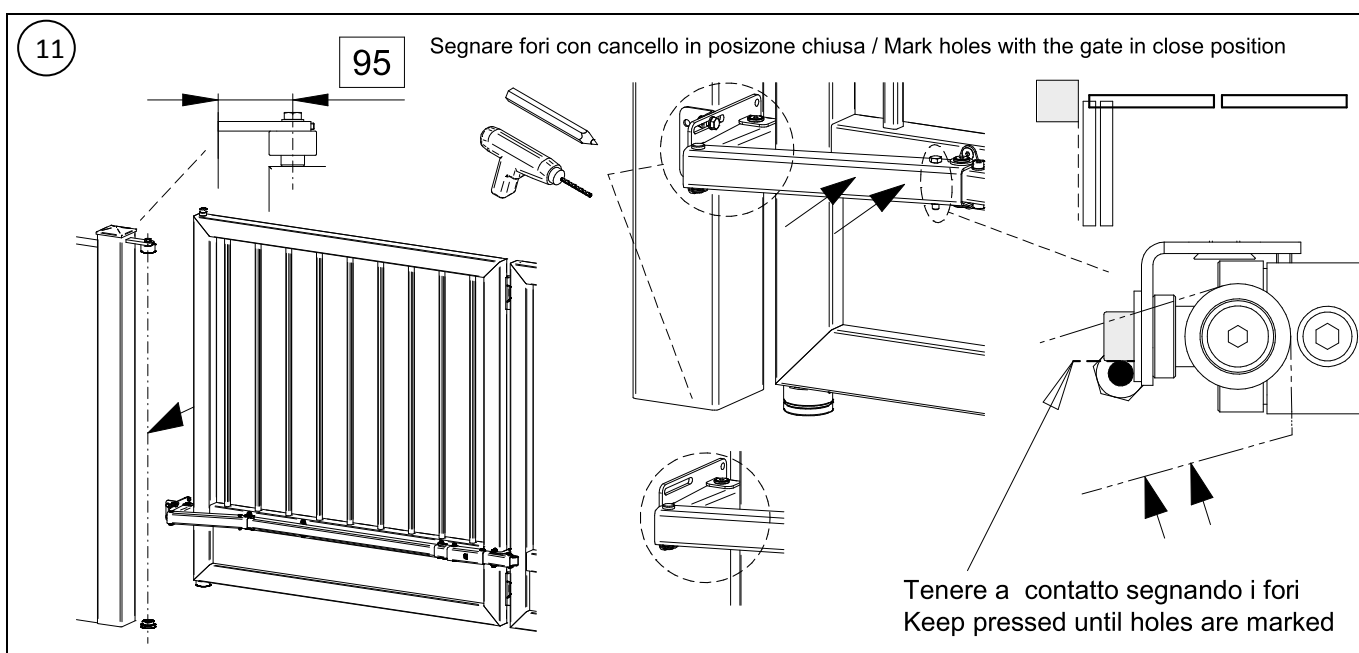
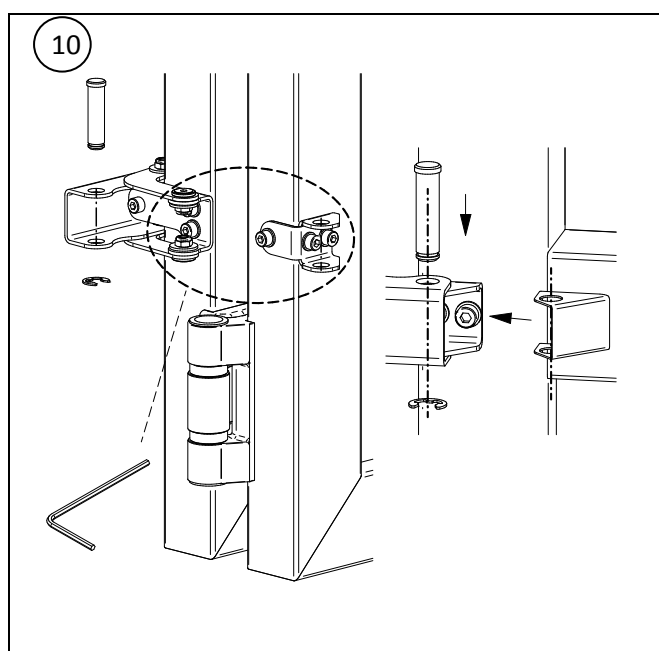
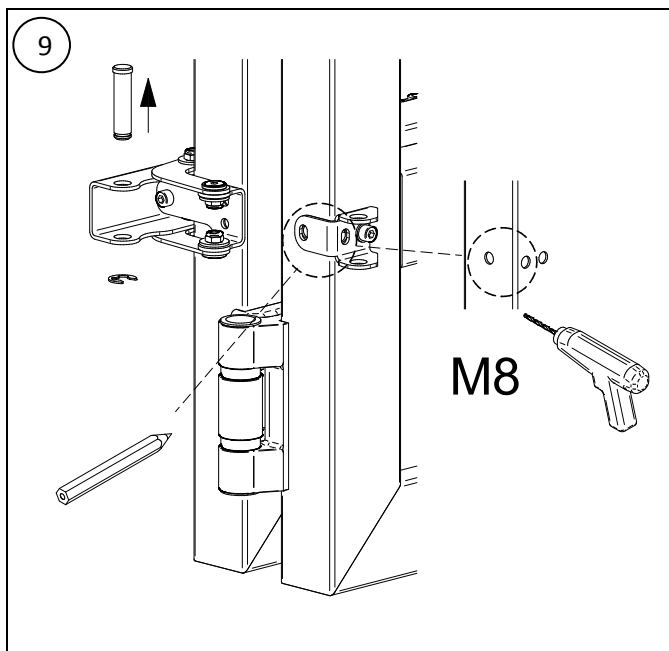

13

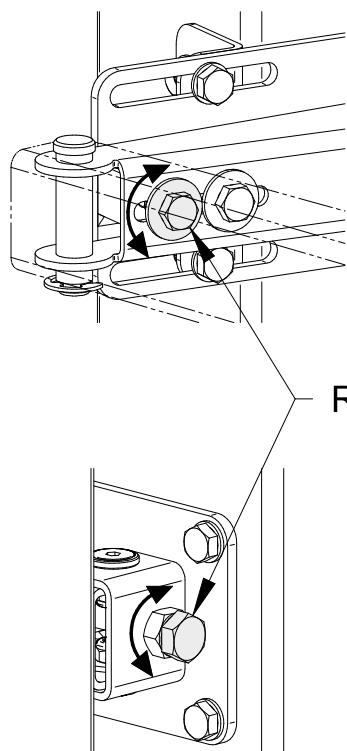

Registrazione/Adjustment



14

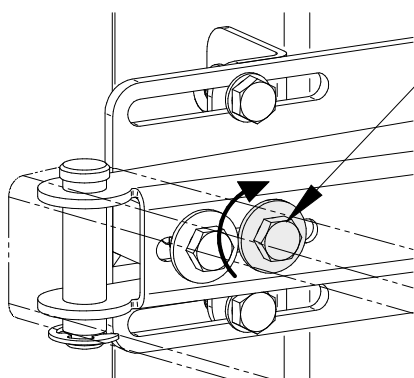

Fissaggio/Fixing

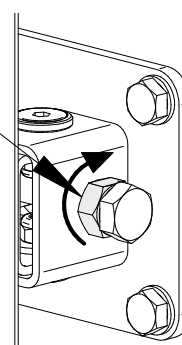

15

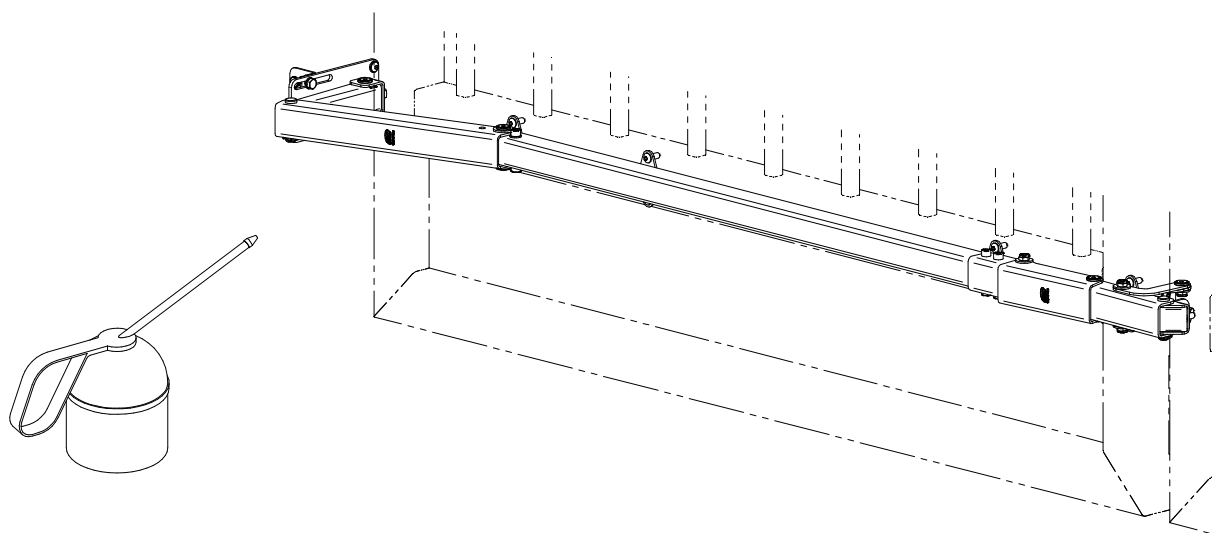

**Attention:** installations that do not comply with the illustrated procedure or failure to carry out correct maintenance operations can cause the gate to derail and endanger the safety of persons and property

## TABELLA DIMENSIONAMENTO - DIMENSIONING TABLE

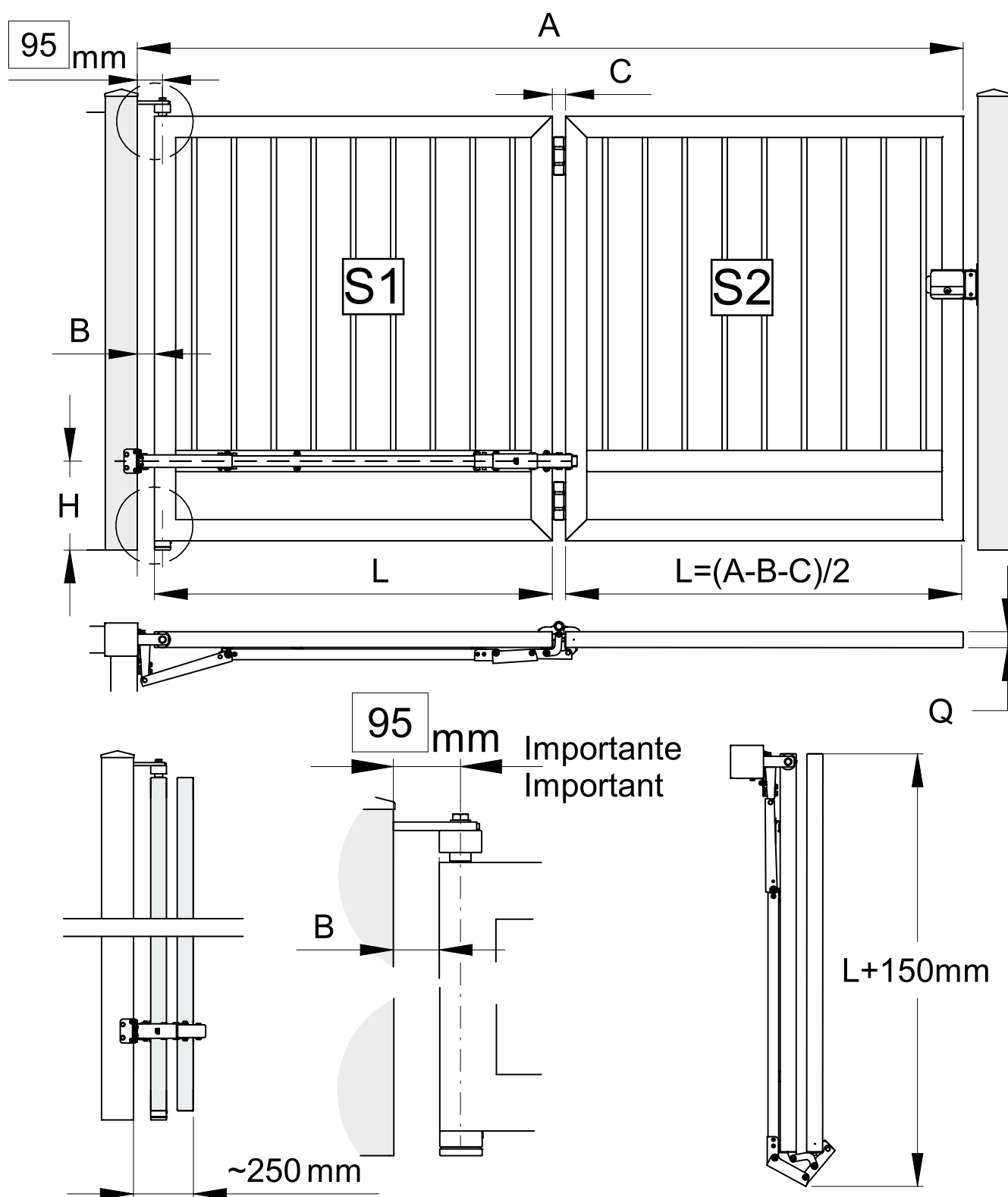

### TABELLA DIMENSIONI - DIMENSION TABLE

| A min-max<br>[m] | B min<br>[mm] | C min<br>[mm] | H               | L min<br>[m] | Q<br>[mm] |
|------------------|---------------|---------------|-----------------|--------------|-----------|
| 1,9 - 5          | 65            | 50            | a piacere -free | 0,89         | 40-50-60  |



**Attention:** installations that do not comply with the illustrated procedure or failure to carry out correct maintenance operations can cause the gate to derail and endanger the safety of persons and property

| A[m] | L [m]<br>con/with B=0,07 |
|------|--------------------------|
| 2    | 0,94                     |
| 2,5  | 1,19                     |
| 3    | 1,44                     |
| 3,5  | 1,69                     |
| 4    | 1,94                     |
| 4,5  | 2,19                     |
| 5    | 2,44                     |

### Esempio misure fuori tabella Example dimensions not in table

A=2,8m

B=0,07m (min 0,065 m)

C=0,05m (da tabella sopra/from above table)

$$L=(A-B-C)/2$$

$$L=(2,8-0,07-0,05)/2$$

$$L=2,68/2$$

$$L=1.34 \text{ m}$$

## Peso max S2 in funzione della lunghezza L-Max S2 leaf weight according to the L lenght

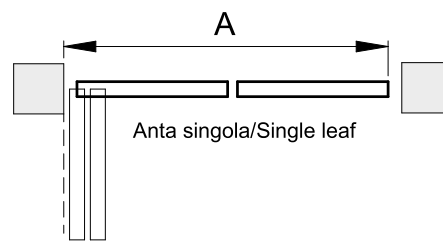
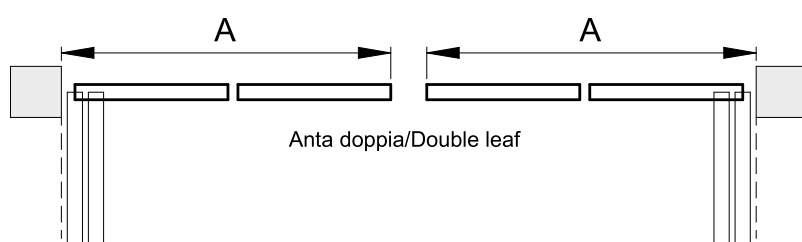
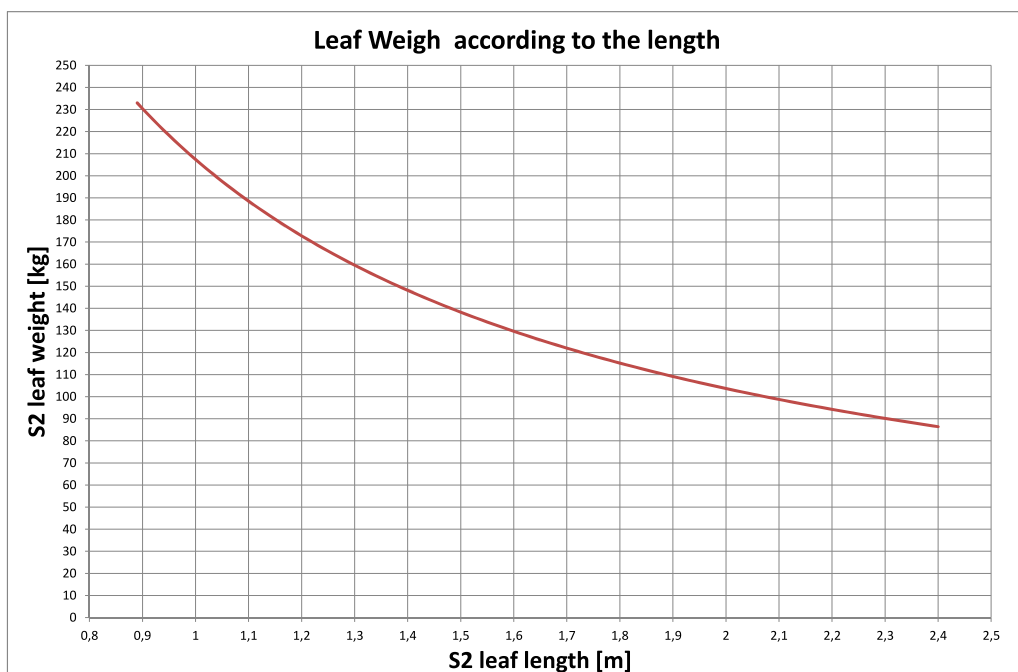

## Maintenance

To maintain these parts in good and safe working conditions it is necessary to follow these steps:

1. After gate assembly is completed, perform a few manual opening and closing cycles, make sure there are no loose parts and periodically lubricate all bearings and junction points.
2. In case of accidental shock caused by moving vehicles or other external factors, check parts for external damages. In case of irreparable damage, replace with a new part. Always check the gate by manually opening a few opening opening and closing cycles. All maintenance procedures must be performed by trained technicians.
3. If the gate has any difficulty of movement or in presence of abnormal oscillations, the gate must be checked for worn parts replaced if necessary. Gates working in harsh ambient conditions, such as; high humidity, salt, acids, dust or temperatures above 120°C will require special attention and frequent maintenance.
4. For motorized gates, pay special attention when selecting the operational speed. Soft starts and stops are highly recommended:
  - High speed of operation, and hard starts and stops will be stressful to the system and it may result in loosen nuts, bolts and irreparable damage.
  - Low operational speeds may cause an elastic effect between the leaves



**Attention:** installations that do not comply with the illusted procedure or or failure to carry out correct maintenance operations can cause the gate to derail and endanger the safety of persons and propriety