

DEA[®]

Operatore elettromeccanico interrato per cancelli ad anta battente

Istruzioni d'uso ed avvertenze

Underground electro-mechanical operator for swing gates

Operating instructions and warnings

Opérateur électromécanique enterré pour portails battants

Notice d'emploi et avertissements

Operador electromecánico enterrado para puertas de hoja batiente

Instrucciones de uso y advertencias

Operador electro-mecânico enterrado para portões de folha batente

Instruções para utilização e advertências

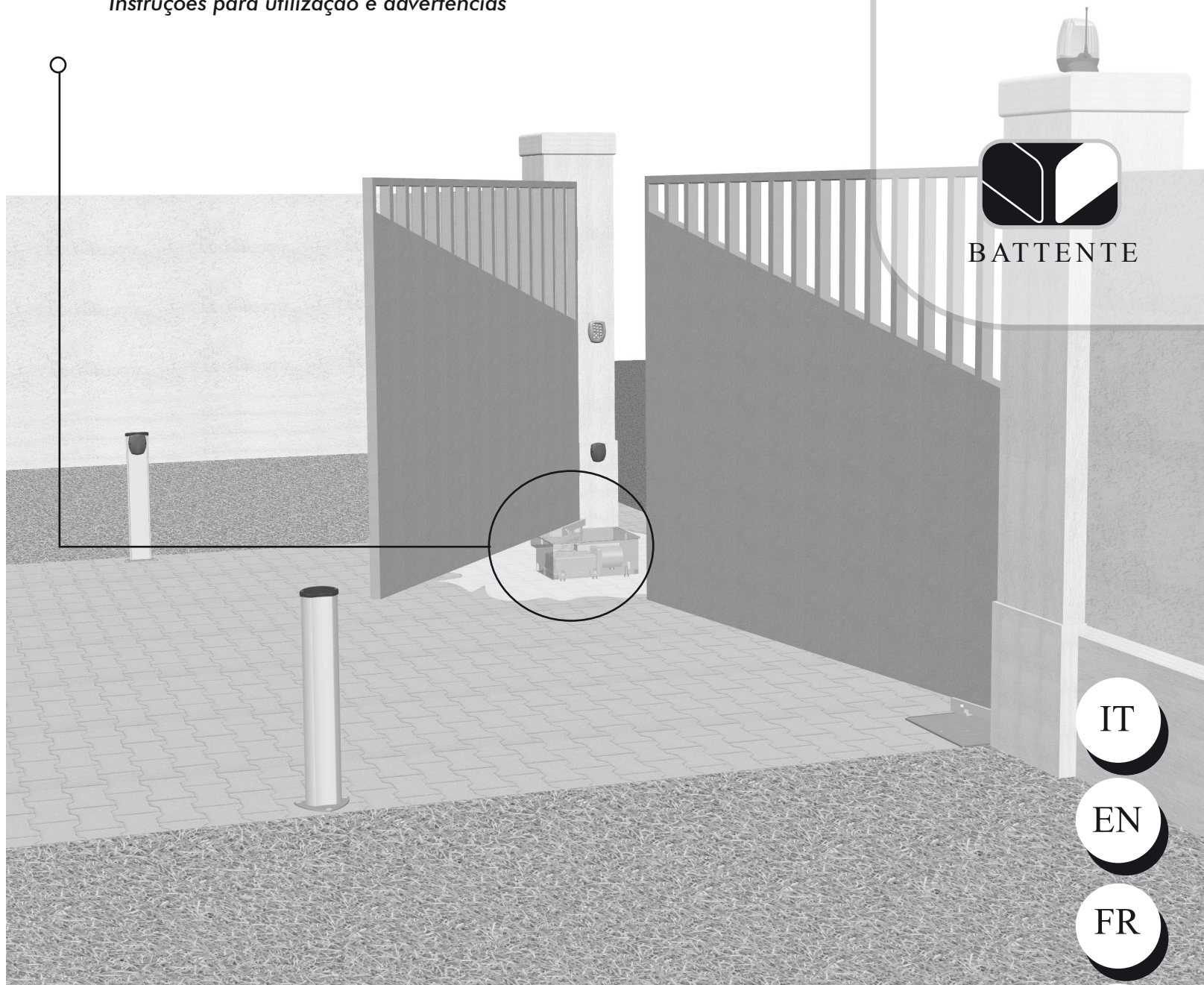

BATTENTE

IT

EN

FR

ES

PT

GHOST 200

GHOST 200

Underground electro-mechanical operator for swing gates
Operating instructions and warnings

ENGLISH

INDEX

Declaration by manufacturer	1
OVERVIEW	7
1 PRODUCT CONFORMITY	7
2 RESIDUAL RISK WARNINGS	7
3 MODELS AND CONTENTS OF THE PACKAGE	8
4 OPERATING INSTRUCTIONS	8
4.1 Product description	8
4.2 Technical data	8
4.3 Labelling information	8
4.4 Appropriate conditions of use	8
4.5 Instructions for risk-free operation	9
4.5.1 Transport – 9	
4.5.2 Installation, assembly and disassembly – 9	
4.5.3 Starting – 9	
4.5.4 Use – 9	
4.5.5 Adjustment – 10	
4.5.6 Maintenance and repair – 10	
4.6 Training	10
4.7 Inappropriate use	10
5 SPARE PARTS LIST	10
6 COMPLETE CLOSING ASSEMBLY	10
6.1 Minimum level of protection provided by the safety edge	10
6.2 Risk of crushing in the opening area ..	10
6.3 Impact in the opening/closing area	10
Example of typical installation	27

ANNEXES

- Instructions for the final user
- Terms of warranty

OVERVIEW

SCOPE OF THE INSTRUCTIONS

These instructions were prepared by the manufacturer and are an integral part of the product. The operations described are intended for adequately trained and qualified operators and must be carefully read and preserved for future reference.

Chapters "2 RESIDUAL RISK WARNINGS" and "4 OPERATING INSTRUCTIONS" contain all the information that **DEA** System provides in order for the product to constantly satisfy the Essential Safety Requirements prescribed by the Machinery Directive (European Directive 2006/42/CE).

Read these chapters carefully because they contain important instructions for safe installation, use and maintenance and important warnings regarding the residual risks remaining even after all the safety devices and measures described have been applied.

The product is designed for installation in complete closing systems subject to specific legislation. Chapter 6 "COMPLETE CLOSING ASSEMBLY" provides useful information for the respect of the Essential Safety Requirements for special types of closing.



1 PRODUCT CONFORMITY

DEA System guarantees the conformity of the product to European Directives 2006/42/CE regarding machinery safety, 2004/108/CE electromagnetic compatibility and 2006/95/CE low voltage electrical equipment. **DEA** System also encloses the manufacturer's Declaration of Conformity with these instructions (see Directive 2006/42/CE Art. 4, paragraph 2).



2 RESIDUAL RISK WARNINGS

 Read these warnings carefully; the failure to respect the following warnings can create risk situations.

WARNING Using this product under unusual conditions not foreseen by the manufacturer can create situations of danger, and for this reason all the conditions prescribed in these instructions must be respected. A1

WARNING Under no circumstances must the product be used in explosive atmospheres or surroundings that may prove corrosive and damage parts of the product. A2

WARNING All installation, maintenance, cleaning or repair operations on any part of the system must be performed exclusively by qualified personnel with the power supply disconnected working in strict compliance with the electrical standards and regulations in force in the nation of installation. A3

WARNING Starting the operator with the lever unit set on the released position may severely injure your arms and legs. Be extremely careful! Release the lever unit only if really necessary: If there is a power supply failure disconnect manually the power supply of the operator by using the apposite switch; in this way, when the power is back you will be able to start the operator only after blocking the lever unit again. A4

WARNING All other adjustment/setting operations beyond the adjustment of the oil flow are made by the manufacturer. Tampering with these settings may cause malfunction and/or situations of risk to people, animals and property. Refrain from performing any operations not authorised by **DEA** System. A5

WARNING Before doing any maintenance operation take off the foundation box lid (by unscrewing the two fixing screws; see F5 page 31); this lid offers protection against the risk of scissor movement due to the presence of moving levers. Once the maintenance operation is completed place back immediately this protection. A6

WARNING Using spare parts not indicated by **DEA** System and/or incorrect re-assembly can create risk to people, animals and property and also damage the product. For this reason, always use only the parts indicated by **DEA** System and scrupulously follow all assembly instructions. A7

WARNING Awareness of the operation of the key-release mechanism (see F8 Page 32) is essential for all users of the automatism because the failure to use the device quickly during emergencies can jeopardise people, animals and property. Enclosure I to these instructions, which the installer is required to deliver to the final user, illustrates operation and can be detached. A8



WARNING To ensure an appropriate level of electrical safety always keep the 230V power supply cables apart (minimum 4mm in the open or 1 mm through insulation) from low voltage cables (motors power supply, controls, electric locks, aerial and auxiliary circuits power supply), and fasten the latter with appropriate clamps near the terminal boards.



WARNING In line with EU Directive 2002/96/EC for waste electrical and electronic equipment (WEEE), this electrical product must not be disposed of as unsorted municipal waste. Please dispose of this product by returning it to your local municipal collection point for recycling.



3 MODELS AND CONTENTS OF THE PACKAGE

The name GHOST 200 identifies a series of underground electro-mechanical operators with different features depending on motor phase power supply and speed.

DEA System articles in the series are listed in the "AVAILABLE MODELS" table.

GHOST 200 is completed by a set of accessories listed in the "PRODUCT ACCESSORIES" table.

Inspect the "Contents of the Package" on Page 30 and compare it with your product for useful consultation during assembly.



4 OPERATING INSTRUCTIONS

In compliance with Directive 2006/42/CE Enclosure I, Point 1.7.4.

4.1 Product description

GHOST 200 is an electromechanical operator for swing gates (see F1, page 30) rotating an articulated arm.

This arm is connected to the gate to be operated by means of the lever unit of the foundation box. The lever unit, that will be properly welded at the time of installation, has a built-in operator unlocking device which will allow you to open the gate even if there is a power supply failure.



4.2 Technical data

See the "TECHNICAL DATA" table.

4.3 Labelling information

Part of the summarised data for the CE label are listed in the label applied to the product (see Position F7, Page 32); the data regarding the seller are found in the enclosed Warranty, while "Indispensable Operating Safety Elements" are found under Point "4.2 Technical data".

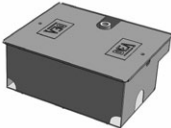
"PRODUCT ACCESSORIES" table

Article Code	Description
215 629000	 Zinc-plated foundation box with release device
215 I 629010	 Stainless steel foundation box with release device
216 629020	 Device to be installed on item art. 215 and 215I to get a 180° angle of opening
218 629030	 Mechanical stop

4.4 Appropriate conditions of use

The GHOST 200 is designed for installation in civil and industrial swing gates as an actuator for the operational automatism as shown in F3 on Page 31. By installing the accessory item 216 you may widen the wing angle of opening up to 180°.

The GHOST 200 has been designed and tested for operation under "normal" civil and industrial gate opening conditions; temperature limits, degrees of protection against dust and water, and other data are provided in Point 4.2 "Technical Data".

Satisfactory operation requires the correct positioning of the GHOST 200 operator with respect to the gate (see F4 page 30).

The required automation must be selected according to the gate to be moved; the attrition on the attachments, the weight, the length/height of the gate wing, and the degree of closing of the surfaces are the elements to be considered. The chart "LENGTH-WEIGHT" correlating the length of the gate leaf and its weight in typical situations can be used in selecting the automation according to the gate to be automated.

	200 - 200CL - 200/EN - 200/CLEN	200L	200/24 - 200/24CL
Motor power supply voltage (V)	230 V ~ ±10% (50/60 Hz)		24 V ---
Absorbed power (W)	400	330	150
Max torque (Nm)	320	300	210
Duty cycle (cycles/hour)	20 - 28 (200/EN)		40
Maximum n° of operations in 24 hour	200		280
Built-in capacitor (µF)	12,5		-
Operating temperature range (°C)	-20 ÷ 50 °C		
Motor thermal protection (°C)	150 °C		-
Opening time 90° (s)	17	26	16
Weight of product with package (Kg)	14,5		14
Protection degree	IP67		

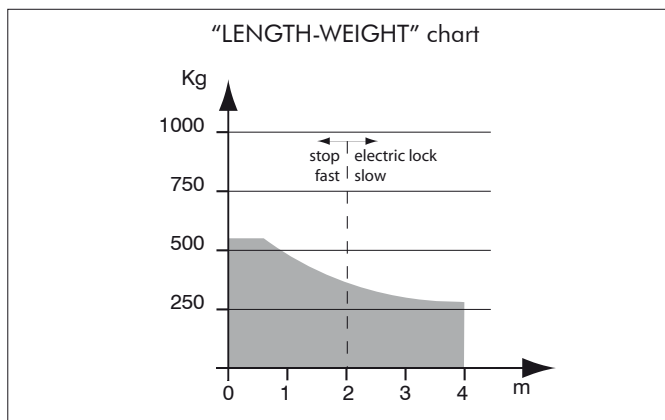

WARNING The use of the product under unusual conditions not foreseen by the manufacturer can create situations of danger, and for this reason all the conditions prescribed in these instructions must be respected. A1

WARNING Under no circumstances must the product be used in explosive atmospheres or surroundings that may prove corrosive and damage parts of the product. A2

4.5 Instructions for risk-free operation

4.5.1 Transport

The GHOST 200 gate operator is always delivered packed in boxes that guarantee the product adequate protection. Carefully read any warnings or instructions for storage and handling provided on the box.

4.5.2 Installation, assembly and disassembly

The following operations are essential to the correct laying of the product:

- the careful definition of the entire automatic opening layout (see also "6 Complete Closing Assembly"); in particular, after carefully assessing the characteristics of the place you have selected, define the model and the correct positioning of the foundation box. (see F2, F3, F4 Page 30 e 31);
- dig a hole and position the foundation box (see F4, page 30);
- check carefully the correct positioning of the foundation box;
- put the foundation box in concrete;
- position the gate and weld the lever unit to the gate;
- cover with the foundation box protective lid.

WARNING All installation, maintenance, cleaning or repair operations on any part of the system must be performed exclusively by qualified personnel with the power supply disconnected working in strict compliance with the electrical standards and regulations in force in the nation of installation. A3

The necessity of installing reinforcement plates must always be carefully assessed, whenever the remaining part of the structure does not appear sufficiently strong, whenever the metal plate used does not appear thick enough or whenever the morphology of the gate appears to lack solidity.

Keep all welding seams well protected from corrosion.

Give extra attention to the alignment of the attachments and their correct vertical positioning.

4.5.3 Starting

The installation of the product requires masonry and/or welding and electrical connection operations using adequate equipment for the job in complete respect of the accident-prevention standards and regulations in force in the nation of installation.

The product must be electrically connected to a special control unit for gate operators; see the instructions provided for such device for further information.

4.5.4 Use

The product is designed for incorporation in the assembly of devices that comprise the gate's automatism. **DEA** System assumes that it will always be used in compliance with the standards and regulations in force.

All GHOST 200 models have an unlocking system; the working of this system is the following: Once you have unlocked with a special key the spring device contained in the lever unit, the operator is released and, if no other obstructions are present, the gate is free to move without hindrance. The opposite procedure, in other words, positioning the gate on the lever unit and blocking the spring device with the apposite special key, returns the GHOST 200 operator to normal working conditions.

WARNING Starting the operator with the lever unit set on the released position may severely injure your arms and legs. Be extremely careful! Release the lever unit only if really necessary: If there is a power supply failure disconnect manually the power supply of the operator by using the apposite switch; in this way, when the power is back you will be able to start the operator only after blocking the lever unit again. A4

"TROUBLE-SHOOTING" table

MALFUNCTION	CAUSES / SOLUTIONS
When the opening command is given, the gate wing fails to move and the operator's electric motor fails to start	The operator is not receiving correct power supply. Check all connections, fuses, and the power supply cable conditions and replace or repair if necessary
When the opening command is given, the motor starts but the gate wing fails to move	Check that the unlocking system is closed (see F8, page 32)
	Make sure that the electronic device for power adjustment is in good condition
	Check if the gate pushes while closing; the motor electrical connections might be inverted
The operator jerks or is noisy during movement	If the wing of the gate does not move freely, release the piston and readjust the rotation points
	Make sure that the electronic device for electric power adjustment is in good condition
	The power of the gearmotor may be insufficient for the characteristics of the gate's wing; check the choice of model whenever required



4.5.5 Adjustment

In order to install standard products no adjustment is required; while to install GHOST 200 with the accessory "mechanical stop art. 218" you will only have to position the stop blocks by unscrewing their fixing screws; then position them correctly, have them run along the opposite slots and tighten up the two screws again (see F6 page 32)

WARNING All the other adjustment/setting operations beyond the adjustment of the oil flow are made by the manufacturer. Tampering with these settings may cause malfunction and/or situations of risk to people, animals and property. Refrain from performing any operations not authorised by **DEA** System.

4.5.6 Maintenance and repair

Good preventive maintenance and regular inspection ensure long working life (see also "Warranty"). Consult the "TROUBLE-SHOOTING" table (see page 9) whenever anomalies are observed in order to find the solution to the problem and contact **DEA** System directly whenever the solution required is not provided.

The inspection/maintenance operations to be routinely scheduled in the "complete automation maintenance handbook" are:

INTERVENTION TYPE	PERIODICITY
cleaning of external	6 months
checking of screw tightening	6 months
checking of release mechanism operation	6 months
check that water flows out properly from the foundation box	6 months
greasing of articulated joint	1 year

WARNING Before doing any maintenance operation take off the foundation box lid (by unscrewing the two fixing screws; see F5 page 30); this lid offers protection against the risk of scissor movement due to the presence of moving levers. Once the maintenance operation is completed place back immediately this protection. A6

WARNING All installation, maintenance, cleaning or repair operations on any part of the system must be performed exclusively by qualified personnel with the power supply disconnected working in strict compliance with the electrical standards and regulations in force in the nation of installation. A3

WARNING The use of spare parts not indicated by **DEA** System and/or incorrect re-assembly can create risk to people, animals and property and also damage the product. For this reason, always use only the parts indicated by **DEA** System and scrupulously follow all assembly instructions. A7

4.6 Training

After installation and setting, the correct operation of the complete automatism must be carefully illustrated to the final user.

GHOST 200 gate operator requires careful instruction on the release mechanism (see "Enclosures") and on the specific maintenance schedule (see Point 4.5.6.).

WARNING Awareness of the operation of GHOST 200 key-release mechanism (see F8 Page 32) is essential for all users of the automatism because failure to use the device quickly during emergencies can jeopardise people, animals and property. Enclosure I to these instructions, which the installer is required to deliver to the final user, illustrates operation and can be detached.

4.7 Inappropriate use

Chapter "4.4 Appropriate conditions of use" describes the conditions for which the product has been designed and tested. The product must never be used for other purposes.

WARNING The use of the product under unusual conditions not foreseen by the manufacturer can create situations of danger, and for this reason all the conditions prescribed in these instructions must be respected. A1

WARNING Under no circumstances must the product be used in explosive atmospheres or surroundings that may prove corrosive and damage parts of the product. A2



5 SPARE PARTS LIST

The list of spare parts that can be ordered (Pages 28 and 29) is a detailed list that accompanies the exploded view of the product and must be used to order spare parts.

The following data must always be provided when ordering spare parts:

- the code of the product (seen on the product label; see F7, Page 32),
- the part's position number in the exploded view,
- if available, the product's purchase date may be useful in some cases.



6 COMPLETE CLOSING ASSEMBLY

This chapter illustrates the typical installation of a complete automation for the purpose of informing and assisting the installer in the selection of the various parts to be used in compliance with Machinery Directive (2006/42/CE) and European Safety Standards (EN 12453 - EN 12445) for gate installation.

The data provided in this chapter are neither complete nor exhaustive, and **DEA** System declines all liability for any errors, omissions or inaccuracies that may occur.

6.1 Minimum level of protection provided by the safety edge

Among the most serious risks to be considered when automating of a swing gate is the risk of crushing between two wings or between one wing and its stop during closing. Regulations prescribe the adoption of one of the following types of controls against such risks depending on the use foreseen for the gate.

An appropriate type of operating control board must be used according to the gate type and according to its usage, as provided for by the quoted regulations (see "OPERATING CONTROL" table).

6.2 Risk of crushing in the opening area

The risk of being crushed can also arise in the area between the gate opening and the wall or fence behind it. F9 on Page 32 provides the measurements that must be observed whenever measures are not taken to limit the impact force or whenever presence detection systems are not used.

6.3 Impact in the opening/closing area

In order to avoid being crushed by the gate wing in the closing area, install a pair of photocells (A) (recommended height: 500 mm) in order to detect the presence of the test parallelepiped (B) (height: 700 mm) positioned as shown in F10 on Page 32.

Note. The presence detection test sample is a parallelepiped with 3 sides with light-coloured reflecting surfaces and 3 sides with dark-coloured, opaque surfaces.

In order to further reduce the risk of impact with the gate wing in the opening area, an extra pair of photocells (C) (recommended height: 500 mm) can be installed for the detection of the presence of the test parallelepiped (D) (height: 700 mm) positioned as shown in F10 on Page 32.



"EXAMPLE OF TYPICAL INSTALLATION" picture

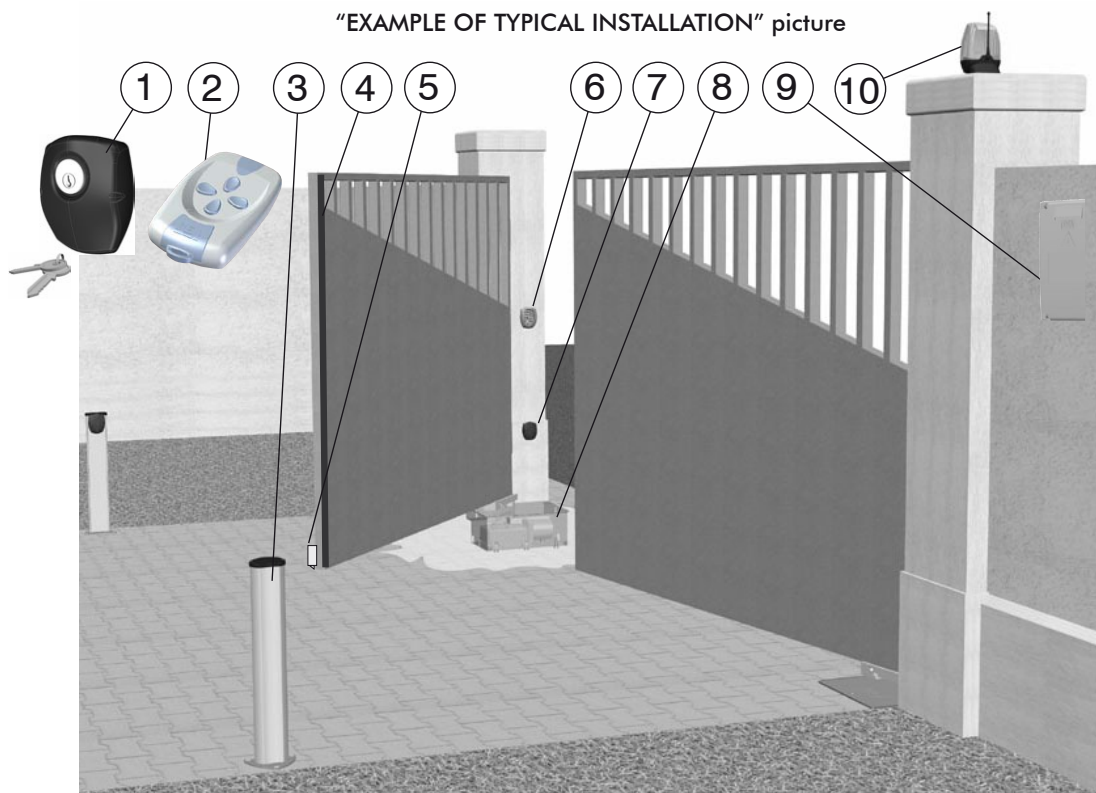

Pos.	Description
1	102 Lux key switch
2	Remote-control
3	Pilly 60 column
4	Safety edge
5	Electric lock
6	FLIC/rad digital keypad
7	104 Lux series photocells
8	GHOST
9	Control board
10	Lumy flashing light

"OPERATING CONTROL" table

Type of control	Type of use		
	Informed users (private areas)	Informed users (public areas)	Uninformed users
Person-present control	Pushbutton control	Pushbutton control with key	The person-present control is not possible
Pulse control with the gate in sight	Force limitation or presence detectors	Force limitation or presence detectors	Force limitation and photocells or presence detectors
Pulse control with the gate not in sight	Force limitation or presence detectors	Force limitation and photocells or presence detectors	Force limitation and photocells or presence detectors
Automatic control (i.e. control with timed closing)	Force limitation and photocells or presence detectors	Force limitation and photocells or presence detectors	Force limitation and photocells or presence detectors

RESPONSIBILITIES OF THE INSTALLER

Remember that anyone who sells and/or motorises doors/gates becomes the manufacturer of the automatic door/gate machine and must therefore prepare and preserve a **technical folder** that contains the following documents (see Machinery Directive Enclosure V):

- Assembly drawing of the automatic door/gate;
- Electrical connection and control circuit wiring diagram;
- Risk analysis including: a list of the essential safety requirements provided in Machinery Directive Enclosure I; a list of the risks posed by the door/gate and the description of the solutions adopted.
- Keep these operating instructions in a safe place together with the instructions for all the other components;
- Prepare these operating instructions and general safety warnings (by filling in these operating instructions) and hand a copy to the final user;
- Fill in the maintenance handbook and hand a copy to the final user;
- Draft the CE declaration of conformity and hand a copy to the final user;
- Fill in the complete CE label or plate and apply it to the door/gate.

Note: The technical folder must be preserved for inspection by the competent national authorities for at least ten years from the date of construction of the automatic door/gate.

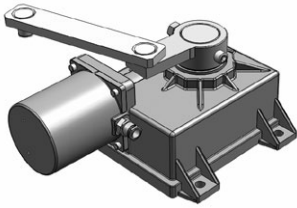

GHOST 200

GARANZIA / WARRANTY / GARANTIE / GARANTÍA / GARANTIA

Compilare e spedire alla ditta costruttrice il presente tagliando affinché la garanzia sia valida.
Fill out and send this coupon to the manufacturer in order to qualify for warranty coverage.
Remplissez le présent coupon puis envoyez-le au constructeur pour valider la garantie.
Compile y envíe al fabricante este cupón para que la garantía sea válida.
Preencha e envie à empresa fabricante o presente cupom para a vossa garantia ser válida.

Apparecchio - Equipment - Appareil - Aparato - Aparelho	
Apparecchio tipo Equipment type Type d'appareil Tipo de aparato Tipo de aparelho	
Data di installazione Installation date Date d'installation Fecha de instalación Data de instalação	N° di matricola Serial number N° de série N° di matrícula N.° de série

Rivenditore - Dealer - Revendeur Distribuidor - Revendedor	Installatore - Installer - Installateur Instalador - Técnico Instalador

Utilizzatore - User - Utilisateur - Usuario - Utilizador	
Nome First name Prénom Nombre Nome	Cognome Surname Nom Apellidos Apelido
Via Address Adresse Calle Morada	Città City Ville Localidad Cidade
Provincia Province Province Provincia Província	Stato Nation État País País



DEA SYSTEM S.p.A.
Via Della Tecnica, 6
ITALY - 36013 PIOVENNE ROCCHETTE (VI)
tel. +39 0445 550789 - fax +39 0445 550265
Internet <http://www.deasystem.com>
e-mail: deasystem@deasystem.com

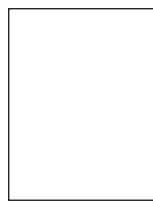

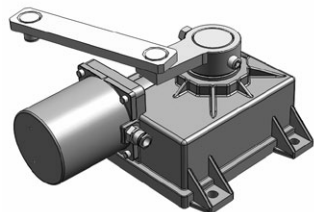

GHOST 200



ISTRUZIONI PER L'UTENTE FINALE

Questa guida è espressamente realizzata per gli utenti dell'automatismo; l'installatore ha il compito di consegnarla ed illustrarla ad un responsabile dell'impianto il quale si preoccuperà dell'informazione a tutti gli altri utenti. E' importante che queste istruzioni siano conservate e rese facilmente disponibili.

Una buona manutenzione preventiva ed una regolare ispezione al prodotto ne assicurano una lunga durata. Contattare regolarmente l'installatore per la manutenzione programmata ed in caso di guasto.

REGOLE DI SICUREZZA

1. Durante il funzionamento dell'automatismo rimanere sempre ad una adeguata distanza di sicurezza e non toccare alcun elemento.
2. Impedire ai bambini di giocare nelle immediate vicinanze dell'automatismo.
3. Eseguire i controlli e le ispezioni previste nel programma di manutenzione; nel caso di funzionamento anormale non utilizzare l'automatismo.
4. Non smontare parti! Le operazioni di manutenzione e riparazione devono essere eseguite da personale qualificato.
5. Può accadere che l'operazione di sblocco si debba realizzare in situazioni di emergenza! Istruire bene tutti gli utenti sul funzionamento dello sblocco e sull'ubicazione delle chiavi di sblocco.

SBLOCCO DI GHOST 200

Tutti i modelli di GHOST 200 sono dotati di un dispositivo di sblocco; il funzionamento di tale dispositivo è il seguente. Una volta sbloccato il dispositivo a molla contenuto nel gruppo leva con l'apposita chiave speciale, l'automatismo è sbloccato e il cancello, in assenza di altri impedimenti è libero nei suoi movimenti. Il procedimento inverso, portare il cancello sul gruppo leva e bloccaggio del dispositivo a molla con l'apposita chiave speciale, riporta GHOST 200 in condizioni di lavoro.

PULIZIA ED ISPEZIONI

L'unica operazione che l'utente può e che deve fare è quella di rimuovere da GHOST 200 foglie, rami e ogni altro detrito che ne ingombri il movimento. Attenzione! Operare sempre in mancanza di tensione!

CONDIZIONI DI GARANZIA

La garanzia sui nostri prodotti è di 24 mesi dalla data di installazione. La garanzia è limitata esclusivamente alla riparazione o sostituzione gratuita dei pezzi riconosciuti difettosi. La garanzia non è valida se i prodotti sono stati manomessi, modificati, installati in modo non corretto o privi di etichetta di identificazione con codice e data di produzione.



INSTRUCTIONS FOR THE FINAL USER

This guide has been prepared for the final users of the automatism; the installer is required to deliver this guide and illustrate its contents to the person in charge of the system. The latter must then provide similar instruction to all the other users. These instructions must be carefully conserved and easily available for consultation when required.

Good preventive maintenance and frequent inspection ensures the long working life of the product. Contact the installer regularly for routine maintenance and in event of anomaly.

SAFETY RULES

1. Always keep a safe distance from the automatism during operation and never touch any moving part.
2. Prevent children from playing near the automatism.
3. Perform the control and inspection operations prescribed in the maintenance schedule and immediately stop using the automatism whenever signs of malfunction are noted.
4. Never disassemble parts of the product! All maintenance and repair operations must be performed only by qualified personnel.
5. The release operation must sometimes be performed in emergencies! All users must be instructed on the use of the release mechanism and the location of the release keys.

GHOST 200 RELEASE MECHANISM

All GHOST 200 models have an unlocking system; the working of this system is the following: Once you have unlocked with a special key the spring device contained in the lever unit, the operator is released and, if no other obstructions are present, the gate is free to move without hindrance. The opposite procedure, in other words, positioning the gate on the lever unit and blocking the spring device with the apposite special key, returns the GHOST 200 operator to normal working conditions.

CLEANING AND INSPECTIONS

The only operation that the user can and must do is to remove branches, leaves, and any other object that might obstruct the gate's free movement. Warning! Always disconnect the power supply whenever performing operations on the gate!

TERMS OF WARRANTY

Our products are covered by warranty for 24 months from the date of installation. Coverage is limited exclusively to the free repair or replacement of parts recognised as defective. Warranty coverage will not be provided whenever the products have been tampered with, modified or installed incorrectly or whenever the identification labels with the respective codes and production dates are missing.



INSTRUCTIONS POUR L'UTILISATEUR FINAL

Ce guide a été réalisé exprès pour les utilisateurs de l'automatisation. L'installateur doit le remettre et le commenter à un responsable de l'installation, qui répercutera l'information à tous les autres utilisateurs. Il est important de garder ces instructions, et elles doivent être facilement accessibles.

Une bonne maintenance préventive et une inspection régulière du produit assurent sa longue durée. Contactez l'installateur régulièrement pour la maintenance programmée, et en cas de panne.

RÈGLES DE SÉCURITÉ

1. Pendant le fonctionnement de l'automatisation restez toujours à une certaine distance de sécurité, et ne touchez aucun élément.
2. Empêchez les enfants de jouer dans les alentours immédiats de l'automatisation.
3. Effectuez les vérifications et les inspections prévues dans le programme de maintenance. En cas de fonctionnement anormal, n'utilisez pas l'automatisation.
4. Ne démontez pas les pièces! Les opérations de maintenance et de réparation doivent être exécutées par du personnel qualifié.
5. Il peut arriver que l'opération de déverrouillage doive se dérouler dans des situations d'urgence! Instruisez bien tous les utilisateurs sur le fonctionnement du déverrouillage et sur la position des clés de déverrouillage.

DÉVERROUILLAGE DE GHOST 200

Tous modèles du GHOST 200 sont équipés d'un dispositif de déverrouillage; le fonctionnement de ce dispositif pour les est le suivant: une fois déverrouillé le dispositif à ressort dans le groupe du levier par la clé spécifique prévue à cet effet, l'opérateur est déverrouillé et le portail, sans autres entraves, est libre de manoeuvrer. Le procédé inverse, soit porter le portail sur le groupe du levier et verrouiller le dispositif à ressort ramène le GHOST 200 dans ses conditions de travail.

NETTOYAGE ET INSPECTIONS

La seule opération que l'utilisateur peut et doit faire est de débarrasser GHOST 200 des feuilles, des brindilles et de tout autre débris qui pourrait entraver sa manoeuvre. Attention! Opérez toujours quand la tension est coupée!

CONDITIONS DE GARANTIE

La garantie sur nos produits est de 24 mois à compter de la date d'installation. La garantie concerne exclusivement la réparation ou le remplacement gratuit des pièces qui ont été reconnues défectueuses. La garantie n'est pas valable si les produits ont été manipulés, modifiés, installés d'une manière incorrecte ou débarrassés de leur étiquette d'identification portant leur code et la date de production.



ES

INSTRUCCIONES PARA EL USUARIO FINAL

Esta Guía se ha realizado expresamente para los usuarios del automatismo; el instalador tiene el deber de entregarla y explicarla a un responsable de la instalación quien se preocupará de informar a todos los demás usuarios. Es importante guardar estas instrucciones y que estén siempre disponibles.

Un buen mantenimiento preventivo y una regular inspección del producto aseguran su larga duración. Contactar regularmente al instalador para el mantenimiento programado y en caso de avería.

REGLAS DE SEGURIDAD

1. Durante el funcionamiento del automatismo, situarse siempre a una adecuada distancia de seguridad y no tocar ningún elemento.
2. Impedir que los niños jueguen en las inmediatas cercanías del automatismo.
3. Realizar los controles y las inspecciones previstas en el programa de mantenimiento; si el funcionamiento fuera anormal, no utilizar el automatismo.
4. No desmontar ninguna parte. Las operaciones de mantenimiento y reparación deben efectuarlas personal autorizado.
5. Es posible que la operación de desbloqueo deba realizarse en situaciones de emergencia. Todos los usuarios tienen que estar debidamente instruidos sobre el funcionamiento del desbloqueo y sobre la ubicación de las llaves de desbloqueo.

DESBLOQUEO DE GHOST 200

Todos los modelos de GHOST 200 incluyen un dispositivo de desbloqueo; el funcionamiento de este dispositivo es el siguiente. Una vez desbloqueado el dispositivo de muelle contenido en el grupo palanca con la correspondiente llave especial, el automatismo queda desbloqueado y la puerta, si nada lo impide, se mueve libremente. El procedimiento contrario, llevar la puerta sobre el grupo palanca y bloqueo del dispositivo de muelle con la correspondiente llave especial, predispone de nuevo GHOST 200 en condiciones de trabajo.

LIMPIEZA E INSPECCIONES

La única operación que el usuario puede y debe hacer es la de retirar de GHOST 200 las hojas, ramas y otros residuos que impidan sus movimientos. ¡Atención! Estas operaciones deben efectuarse tras haber desconectado el suministro eléctrico.

CONDICIONES DE GARANTÍA

La garantía de nuestros productos dura 24 meses desde la fecha de instalación. La garantía se limita exclusivamente a la reparación o sustitución gratuita de las piezas reconocidas defectuosas. La garantía no es válida si los productos han sido forzados, modificados, instalados incorrectamente o carecen de etiqueta de identificación con código y fecha de producción.

PT

INSTRUÇÕES PARA O UTILIZADOR FINAL

Este guia foi expressamente realizado para os utilizadores do automatismo; o técnico de instalação tem a tarefa de entregá-lo e explicá-lo a um responsável pelo equipamento, que se encarregará pela informação a todos os demais utilizadores. É importante guardar e manter estas instruções de maneira que estejam facilmente disponíveis. Uma boa manutenção preventiva e uma regular inspeção do produto asseguram ao mesmo uma longa durabilidade. Contacte periodicamente o técnico de instalação acerca da manutenção programada e caso haja avaria.

REGRAS DE SEGURANÇA

1. Durante o funcionamento do automatismo permaneça sempre a uma adequada distância de segurança e não toque nenhum dos componentes.
2. Impedea que crianças brinquem nas proximidades do automatismo.
3. Efectue as verificações e as inspecções previstas pelo programa de manutenção; no caso de funcionamento anormal não utilize o automatismo.
4. Não desmonte nenhuma peça! As operações de manutenção e reparação devem ser efectuadas por pessoal qualificado.
5. Pode ser necessário efectuar uma operação de desbloqueio em situações de emergência! Instrua bem todos os utilizadores acerca do funcionamento do desbloqueio e da localização das chaves de desbloqueio.

DESBLOQUEIO DO GHOST 200

Todos os modelos de GHOST 200 são equipados com dispositivo de desbloqueio; o funcionamento deste é o seguinte.

Depois de ter soltado o dispositivo de mola contido no grupo de alavanca, usando a chave especial específica, o automatismo estará desbloqueado e o portão, se não houver outros impedimentos, estará desimpedido para os seus movimentos. Com o processo inverso, a colocar o portão no grupo de alavanca e com o bloqueio do dispositivo de mola, usando a chave especial específica, o GHOST 200 voltará às condições de trabalho.

LIMPEZA E INSPECÇÕES

A única operação que o utilizador pode e deve efectuar é retirar do GHOST 200: folhas, ramos e todos os demais detritos que atrapalhem o seu movimento. Atenção! Realize estas operações com a alimentação eléctrica à máquina desligada!

CONDIÇÕES DE GARANTIA

A garantia dos produtos da DEA System é de 24 meses a partir da data de instalação. Esta garantia é limitada exclusivamente à reparação ou substituição gratuita das peças reconhecidas como defeituosas. Esta garantia não é válida se os produtos tiverem sido alterados, modificados, instalados de maneira não correcta ou estejam sem a etiqueta de identificação que contém o código e data de produção.

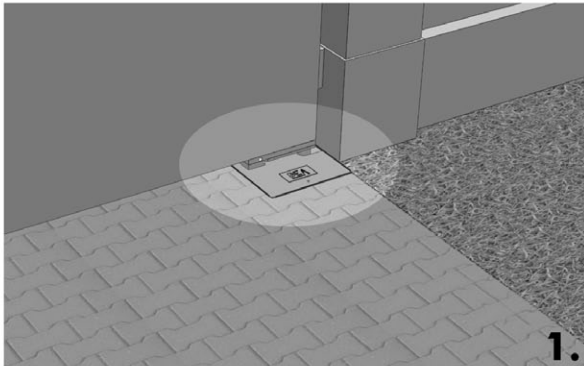

1.

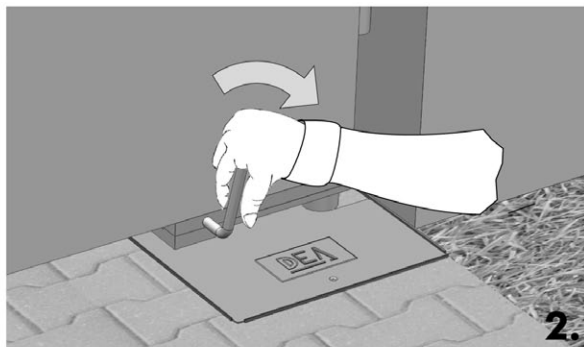

2.

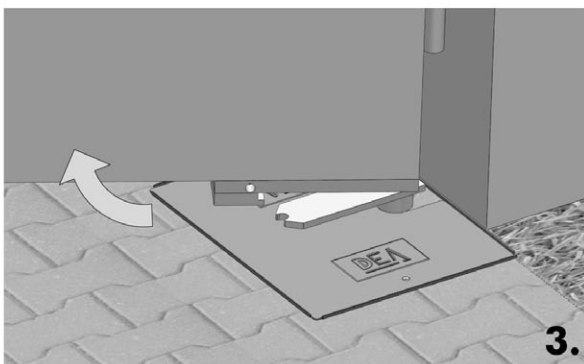

3.

DEA[®]



Esempio di installazione tipica - Example of typical installation - Exemple d'installation typique
Ejemplo de instalación típica - Exemplo de instalação típica

DEA System fornisce queste indicazioni che si possono ritenere valide per un impianto tipo ma che non possono essere complete. Per ogni automatismo, infatti, l'installatore deve valutare attentamente le reali condizioni del posto ed i requisiti dell'installazione in termini di prestazioni e di sicurezza; sarà in base a queste considerazioni che redigerà l'analisi dei rischi e progetterà nel dettaglio l'automatismo.

DEA System provides the following instructions which are valid for a typical system but obviously not complete for every system. For each automatism the installer must carefully evaluate the real conditions existing at the site. The installation requisites in terms of both performance and safety must be based upon such considerations, which will also form the basis for the risk analysis and the detailed design of the automatism.

DEA System fournit ces indications que vous pouvez considérer comme valables pour une installation-type, même si elles ne peuvent pas être complètes. En effet, pour chaque automatisme, l'installateur doit évaluer attentivement les conditions réelles du site et les pré-requis de l'installation au point de vue performances et sécurité ; c'est sur la base de ces considérations

qu'il rédigerà l'analyse des risques et qu'il concevra l'automatisation d'une manière détaillée.

DEA System facilita estas indicaciones que pueden considerarse válidas para una instalación tipo pero que no pueden considerarse completas. El instalador, en efecto, tiene que evaluar atentamente para cada automatismo las reales condiciones del sitio y los requisitos de la instalación por lo que se refiere a prestaciones y seguridad; en función de estas consideraciones redactará el análisis de riesgos y efectuará el proyecto detallado del automatismo.

DEA System fornece estas indicações que podem ser consideradas válidas para o equipamento padrão, mas que podem não ser completas. Para cada automatismo praticamente o técnico de instalação deverá avaliar com atenção as condições reais do sítio e os requisitos da instalação em termos de performance e de segurança; será em função destas considerações que realizará uma análise dos riscos e projectará o

DEA System consiglia di inserire il quadro di comando (scheda elettrica + box) in scatole di derivazione commerciali - DEA System suggests to shelter the control board (control board card + box) inside a connector block box (not supplied) - DEA System vous conseille d'insérer l'armoire de commande dans (carte électronique + boîte) une boîte étanche de dérivation (pas fournie) - DEA System aconseja de insertar el cuadro de maniobra (tarjeta electrónica del cuadro de mando + caja) en una caja de derivación (no provista) - Dea System aconselha instalar o quadro de comando (quadro eléctrico + caixa) numa caixa de derivação (não fornecida)

Per un corretto uso ai fini della sicurezza il motore deve essere collegato unicamente ad una centrale di comando Dea System 224RR o 224RR/B. To ensure proper and safe use of operators, connect them only to Dea System control panels 224RR o 224RR/B. Afin d'assurer un emploi correct au point de vue de la sécurité, le moteur doit être branché à une armoire de commande Dea System 224RR o 224RR/B. Para un empleo correcto en cuanto a seguridad, el motor tiene que conectarse exclusivamente a una central de control Dea System 224RR o 224RR/B. Para um uso certo em relação à segurança, o motor deve ser ligado unicamente a uma central de comando Dea System 224RR o 224RR/B.

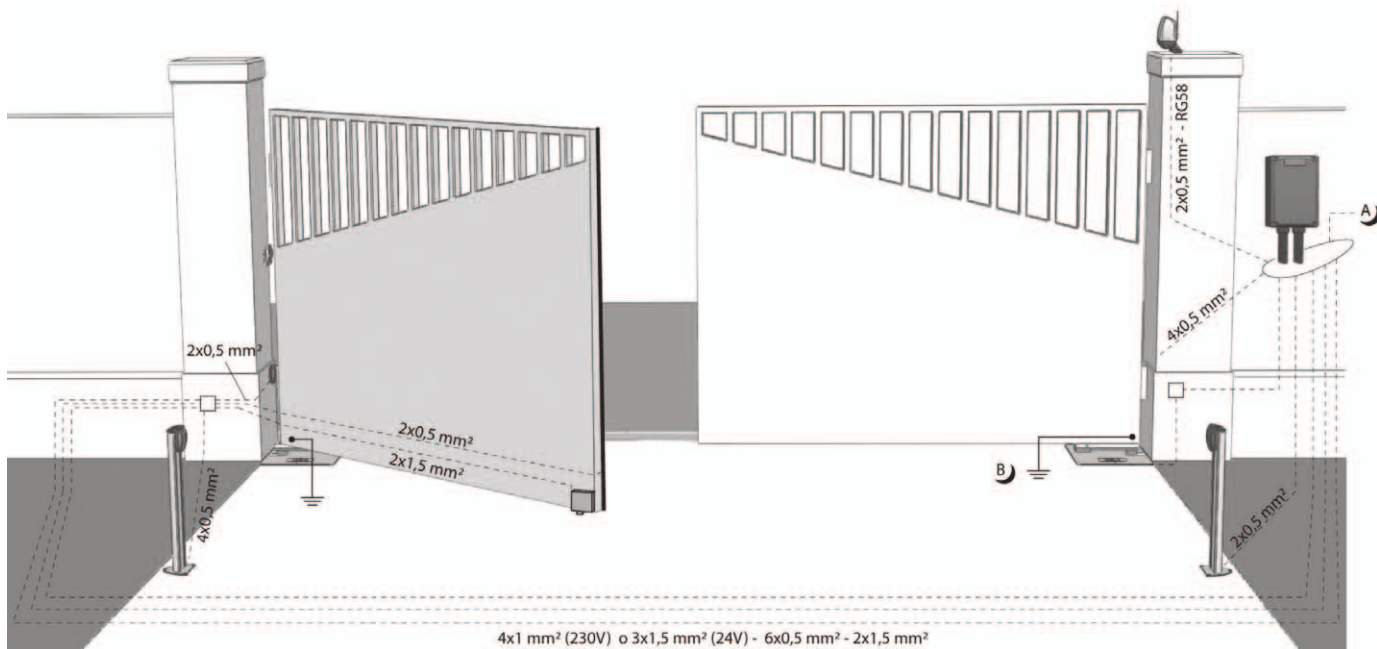

- A)** Collegarsi alla rete 230 V \pm 10% 50-60 Hz tramite un interruttore onnipolare o altro dispositivo che assuri la onnipolare disinserzione della rete, con una distanza di apertura dei contatti \geq 3 mm
Make the 230V \pm 10% 50-60 Hz mains connection using an omnipolar switch or any other device that guarantees the omnipolar disconnection of the mains network with a contact opening distance of 3 mm
Connectez-vous au réseau 230 V \pm 10% 50-60 Hz au moyen d'un interrupteur omnipolaire ou d'un autre dispositif qui assure le débranchement omnipolaire du réseau, avec un écartement des contacts égal à 3 mm.
Efectuar la conexión a una línea eléctrica 230 V \pm 10% 50-60 Hz a través de un interruptor omnipolar u otro dispositivo que asegure la omnipolar desconexión de la línea, con 3 mm de distancia de apertura de los contactos.
Ligue na rede de 230 V. \pm 10% 50-60 Hz mediante um interruptor omnipolar ou outro dispositivo que assegure que se desliga de maneira omnipolar da rede, com abertura dos contactos de pelo menos 3 mm. de distância
- B)** Collegare a terra tutte le masse metalliche - All metal parts must be grounded - Connectez toutes les masses métalliques à la terre - Conectar con la tierra todas las masas metálicas - Realize ligação à terra de todas as massas metálicas



Lista parti ordinabili, Spare parts list, Liste pièces ordonnables, Lista partes que pueden encargarse,
Lista para pedido de peças de reposição

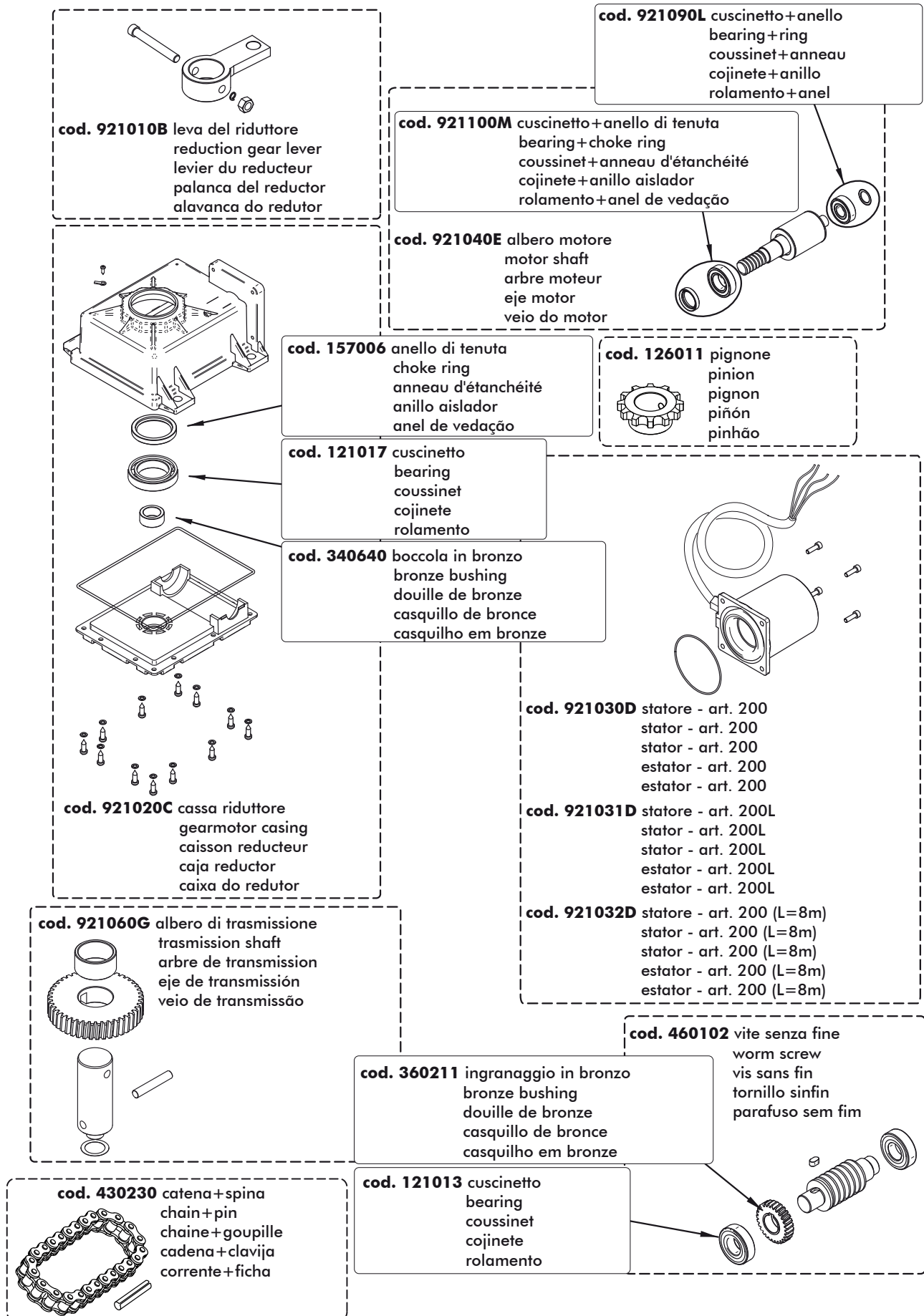



Lista parti ordinabili, Spare parts list, Liste pièces ordonnables, Lista partes que pueden encargarse,
Lista para pedido de peças de reposição

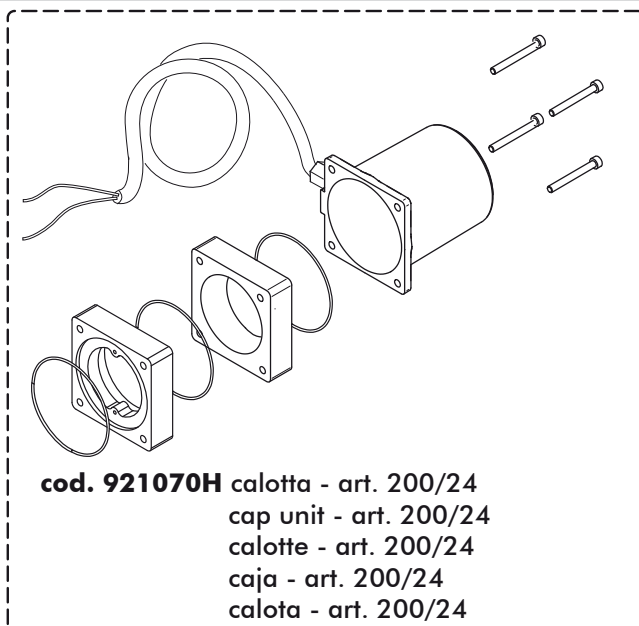

cod. 921070H calotta - art. 200/24
cap unit - art. 200/24
calotte - art. 200/24
caja - art. 200/24
calota - art. 200/24

cod. 121420 cuscinetto
bearing
coussinet
cojinete
rolamento

cod. 921080I motore 24V
24V motor
moteur 24V
motor 24V
motor 24V

cod. 162003 condensatore
capacitor
condensateur
condensador
condensador

cod. 480660 sblocco per cassa di fondazione zinc.
unlocking device for galvanized steel box
déverrouillage pour caisson zingué
desbloqueo para caja de fundación galvanizada
desbloqueio para caixa de fundação zincado

cod. 430110 sacchetto accessori
accessories small bag
sachet accessoires
bolsita accesorios
saco de acessórios

cod. 330610 chiave di sblocco
release key
clavette déverrouillage
chaveta de desbloqueo
chave de desbloqueio

cod. 386191 coperchio neutro inox
neutral stainless steel cover
couvercle neutre inox
tapa neutro inox

cod. 386190 tampa neutra inox
coperchio marchiato inox
marked stainless steel cover
couvercle marqué inox
tapa marcada inox

cod. 386331 tampa com marca inox
coperchio neutro zinc.
neutral galvanized steel cover
couvercle neutre zinqué
tapa neutro galvanizada

cod. 386330 tampa neutra galvanizada
coperchio marchiato zinc.
marked galvanized steel cover
couvercle marqué zinqué
tapa marcada galvanizada
tampa com marca galvanizada

cod. 386180 cassa di fondazione inox
stainless steel foundation box
caisson inox

cod. 386320 cassa di fondazione zinc.
galvanized steel foundation box
caisson zingué
caja de fundación galvanizada
caixa de fundação galvanizada

cod. 350100 piatto biella zinc.
connecting rod lever
levier bielle
plato biela
prato da biela



	Contenuto dell'imballo Contents of the package Contenu de l'emballage Contenido del embalaje Conteúdo da embalagem
	x1
	x4
	x4
Art. 200, 200L	
	x1

F1 Elementi del prodotto, Product elements, Eléments du produit, Elementos del producto, Elementos do produto

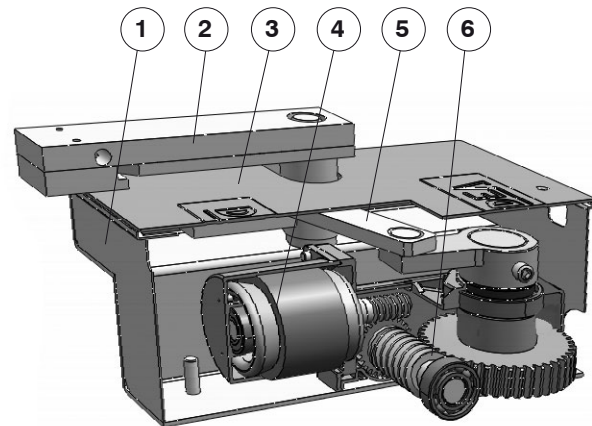

1	2	3	4	5	6
Cassa di fondazione Foundation box Caisse de fondation Caja de cimentación Caixa de fundações	Gruppo leva Lever unit Groupe du levier Grupo palanca Grupo alavanca	Coperchio Lid Couvercle Tapa	Gruppo motore Motor unit Groupe moteur Grupo motor Grupo do motor	Braccio snodato Articulated arm Bras articulé Brazo articulado Braço articulado	Riduttore Operator Réducteur Redutor

F4 Installazione cassa di fondazione, Installation of the foundation box, Installation caisse de fondation, Instalación de la caja de cimentación, Instalação da caixa de fundações

Eeguire il collegamento elettrico all'interno di una scatola di derivazione (pos.2) e non all'interno della cassa di fondazione. - **Make** all electrical connections inside a connector block box (pos. 2) and not in the foundation box. - **Exécutez** le branchement électrique dans une boîte étanche de dérivation (pos. 2) et pas dans la caisse de fondation. - **Efectuar** la conexión eléctrica en el interior de la caja de derivación (pos. 2) y no dentro de la caja de cimentación. - **Efetuar** a conexão eléctrica ao interior de uma caixa de derivação (pos.2) e não no interior da caixa de fundação.

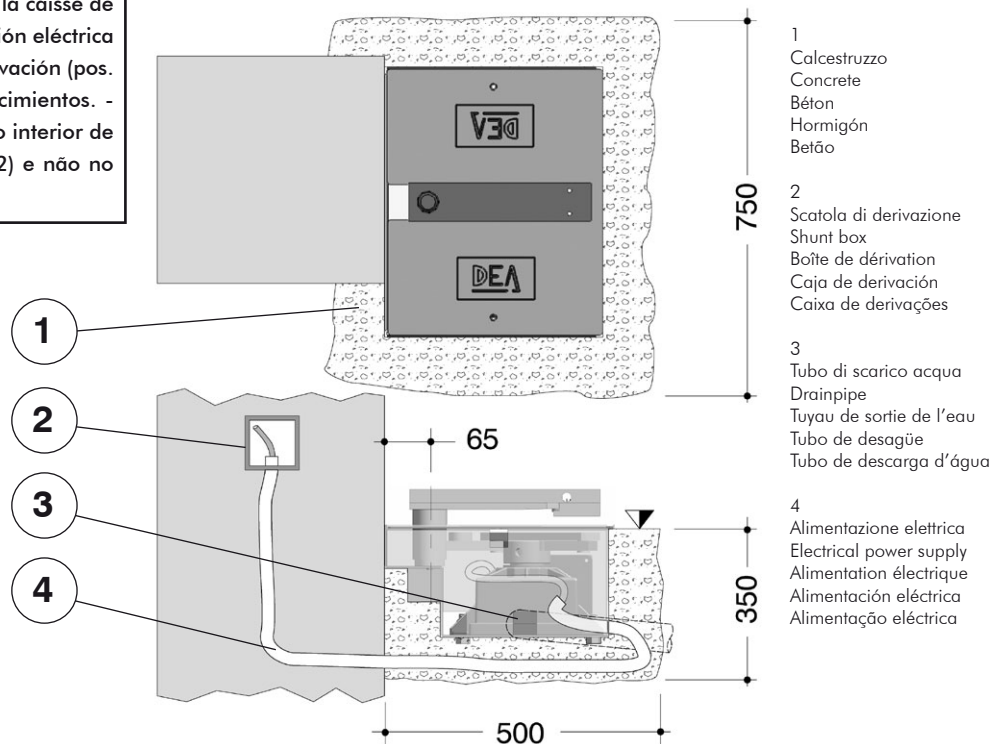



F2 Ingombri prodotto, Product dimensions, Cotes d'encombrement du produit, Espacio ocupado por el producto, Medidas máximas do produto

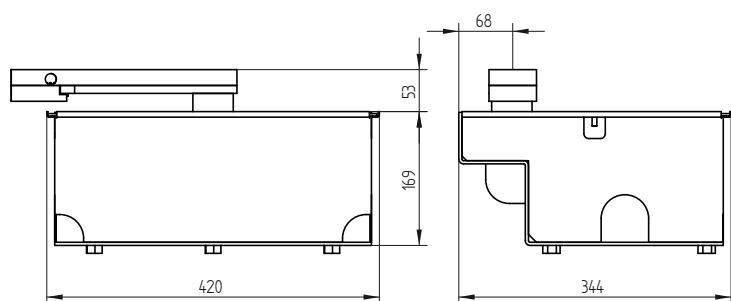

F3 Misure installazione. Installation measurements, Mesures pour l'installation, Medidas instalación, Medidas para instalação

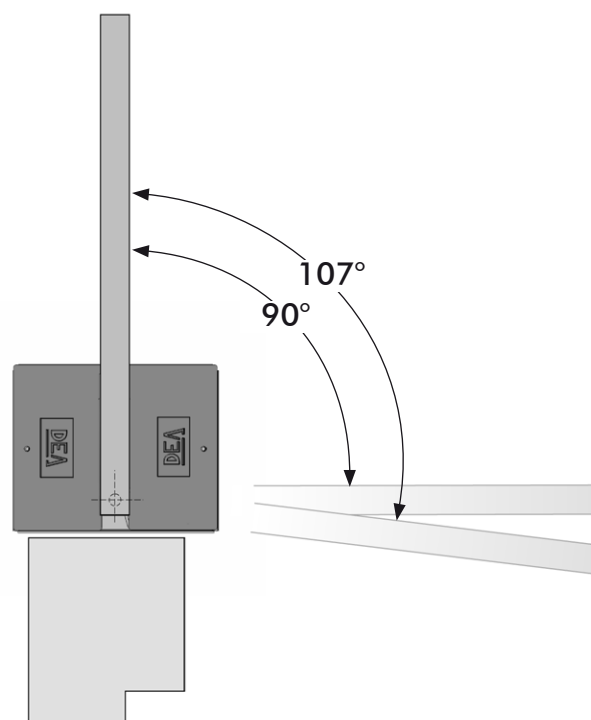

F5 Assemblaggio riduttore, Gearmotor assembly, Assemblage réducteur, Montaje del reductor, Montagem do reductor

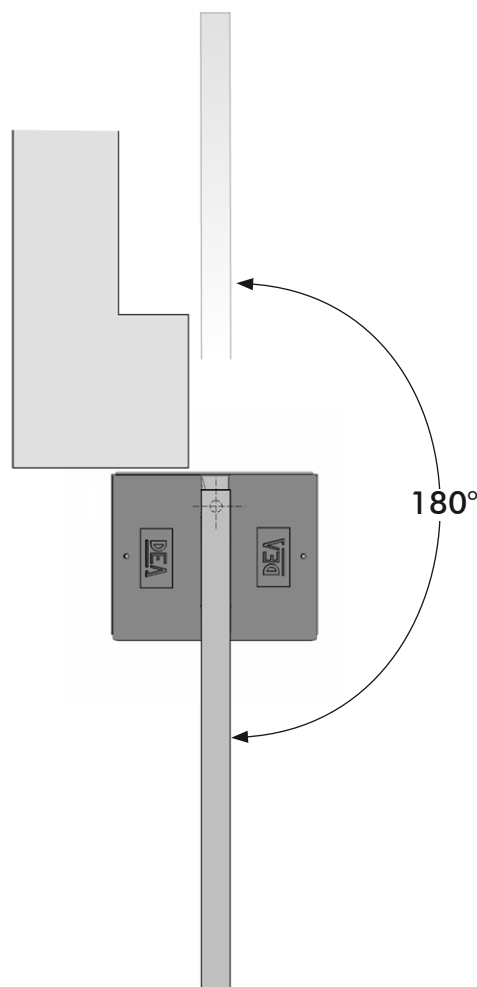
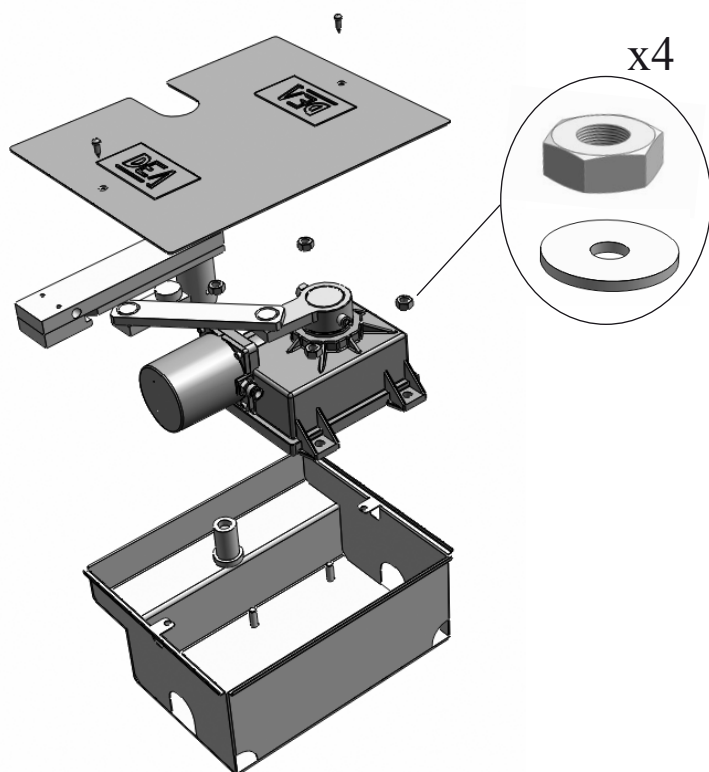



F6 Regolazione finecorsa, Limit switch adjustment,
Réglage fin de course, Regulación tope,
Regulação do final de percurso

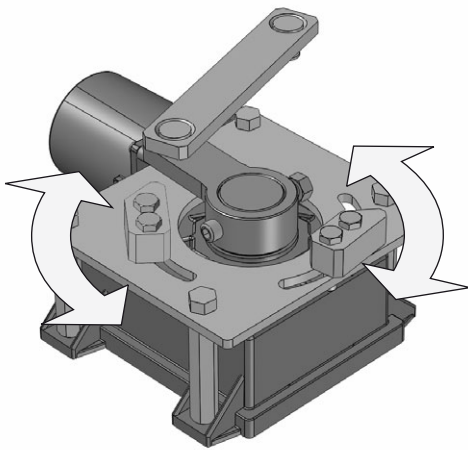

F7 Posizione etichetta, Label position, Position étiquette,
Posición etiqueta, Posição da etiqueta

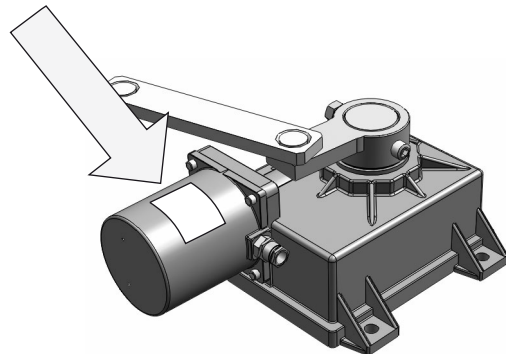

F8 Sblocco manuale, Manual release, Déverrouillage manuel,
Desbloqueo manual, Desbloqueio manual



1.

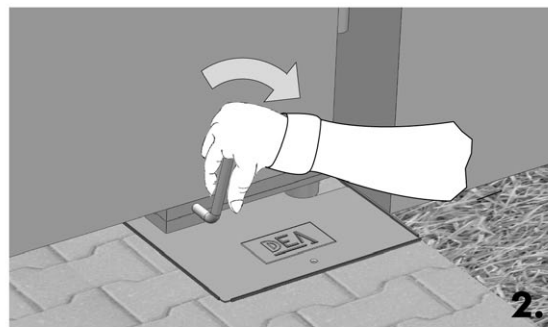

2.

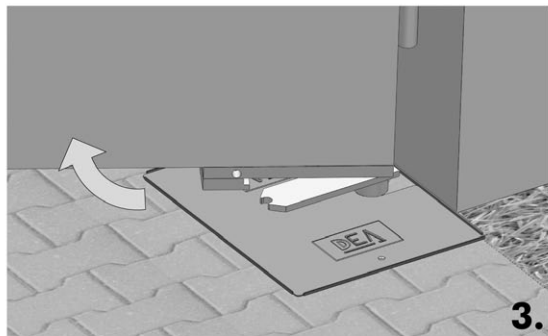

3.

F9 Distanze antischacciamento, Crushing prevention
safety distances, Distances anti-écrasement, Distancias
anti aplastamiento, Distância para evitar esmagamento

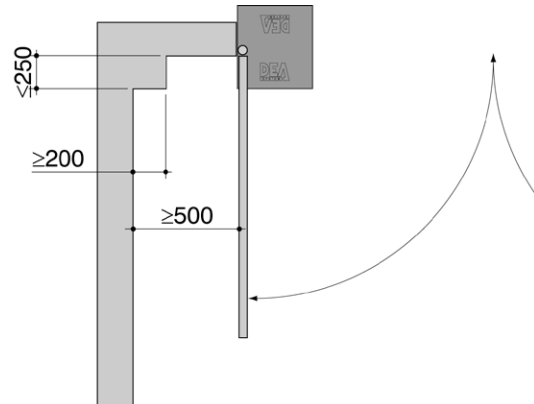

F10 Distanze installazione fotocellule, Photocell instal-
lation distances, Distances installation photocellules, Di-
stancias instalación fotocélulas, Distância da instalação
das fotocélulas

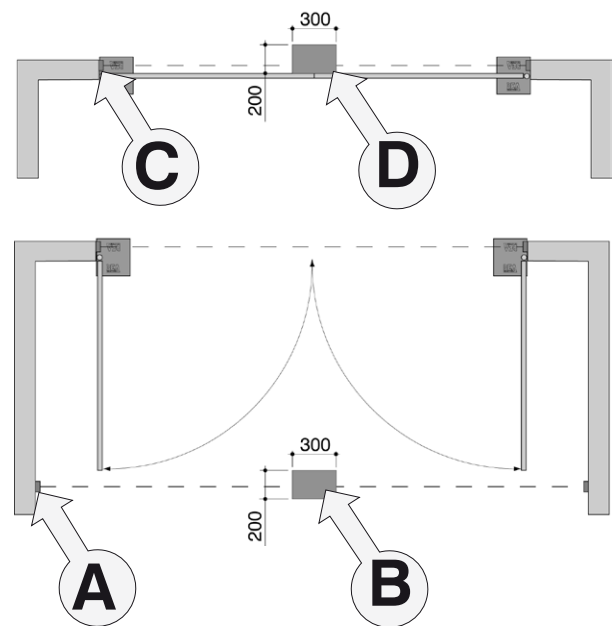

Questo manuale è stato realizzato utilizzando carta ecologica riciclata certificata Ecolabel per contribuire alla salvaguardia dell'ambiente.

This manual was printed using recycled paper certified Ecolabel to help save the environment.

Ce manuel a été réalisé en utilisant du papier recyclé certifié Ecolabel afin de respecter l'environnement.

El manual ha sido fabricado utilizando papel reciclado certificado Ecolabel para preservar el medio ambiente.

Este manual foi impresso com papel reciclado certificado Ecolabel para ajudar a preservar o meio ambiente.

